

Simplicity Round Cardigan
by Kiki Crochet Patterns



- ✓ **This pattern is copyrighted and belongs to Kiki Crochet.**
- ✗ **DO NOT distribute, resell or make any video tutorials of this pattern.**
- ✓ **You may sell any finished items made with this pattern.**

Skill Level: Easy

Size: Women's from S – 5XL

Measurements

The measurements are shown in the chart that I have for each size's description in the pattern.

Material:



Yarn: Cygnet Chunky Acrylic – Size 5 – Bulky Yarn

Total yarn used:

Size S – 1360 yds

Size M – 1530 yds

Size L – 1700 yds

Size XL – 2210 yds

Size 2XL – 2720 yds

Size 3XL – 3070 yds

Size 4XL – 3390 yds

Size 5 XL – 3740 yds

Crochet hook: 6 mm

Wooden shawl pin or a button (I used a wooden shawl pin)

Abbreviations & Stitches Used:

ch – chain

st – stitch

sl st – slip stitch

dc – double crochet

fpdc – front post double crochet

bpdc – back post double crochet

fptr – front post triple crochet – yarn over the hook twice, take hook around the dc of the previous row pulling outwards, grab yarn pull it under the st, the take yarn pull through the 1st 2 loops, take yarn pull though the next 2 loops, take yarn pull through the last 2 loops.

bptr – back post triple crochet – yarn over the hook twice, take hook around the dc of the previous row pulling it backwards, grab yarn pull it under the st, the take yarn pull through the 1st 2 loops, take yarn pull though the next 2 loops, take yarn pull through the last 2 loops

(number) – total number of stitches in the end of the row.

Important Information Before You Start:

- 1) The pattern is written in US Crochet Terms.
- 2) In order to avoid big gaps in the beginning of the rounds of double crochet, instead of chaining 3 (which equal 1 dc), I start with 2 chains, which still count as a double crochet. This means that in the end of every round, we work the sl st in the 2nd ch counting from bottom to top.
- 3) The pattern is written out thoroughly for each size separately.
- 4) In each size you will find a chart with the measurement from shoulder to shoulder, along with the circle diameter in the row before we create the holes for the sleeves and the finished diameter of the cardigan.
- 5) You will find photo instructions for the important steps.
- 6) In the beginning of every row where I state work 1 more dc in the same st, it's worked in the same base as the ch 2.
- 7) There's a step-by-step video tutorial available for the pattern, the link can be found below.

Video Tutorial: <https://youtu.be/kjveB-XNabM>

Size	Shoulder to Shoulder	Diameter of Circle in Row 14	Diameter of Cardigan
Small	37 cm (or 14.5 in)	42 cm (or 16.5 in)	106 cm (or 42 in)

Start with a Magic Circle or Ch 4 and sl st in 1st chain to form ring.

Round 1: If starting with a magic circle, ch 2. If starting with the ch ring, chain 3. In the center of your ring, work 11 dc. Sl st in the 1st of the row (*see above in the “important tips” section how to work your sl st*). (12)

Round 2: Ch 2, turn work and work one more dc in the same st. [Work 2 dc in every stitch all around] x 11. Sl st in the 1st st of the row. (24)

Round 3: Ch 2, turn work and work one more dc in the same st. [Work 1 dc in next st, 2dc in the next one] x 11. Finish row by working 1 dc in the last st. Sl st in the 1st st of the row. (36)

Round 4: Ch 2, turn work and work one more dc in the same st. [Work 1 dc in the next 2 st, 2dc in the 3rd one] x 11. Finish row by working 1 dc in the last 2 st. Sl st in the 1st st of the row. (48)

Round 5: Ch 2, turn work and work one more dc in the same st. [Work 1 dc in the next 3 st, 2dc in the 4th one] x 11. Finish row by working 1 dc in the last 3 st. Sl st in the 1st st of the row. (60)

Round 6: Ch 2, turn work and work one more dc in the same st. [Work 1 dc in the next 4 st, 2dc in the 5th one] x 11. Finish row by working 1 dc in the last 4 st. Sl st in the 1st st of the row. (72)

Round 7: Ch 2, turn work and work one more dc in the same st. [Work 1 dc in the next 5 st, 2dc in the 6th one] x 11. Finish row by working 1 dc in the last 5 st. Sl st in the 1st st of the row. (84)

Round 8: Ch 2 and turn work. Starting from the next st, work 1 dc all around. Sl st in the 1st st of the row. (*in this row, we don't work any increases because the project has started to get a little wavy*). (84)

Round 9: Ch 2, turn work and work one more dc in the same st. [Work 1 dc in the next 6 st, 2dc in the 7th one] x 11. Finish row by working 1 dc in the last 6 st. Sl st in the 1st st of the row. (96)

Round 10: Ch 4, turn work and work one more dc in the same st. [Work 1 dc in the next 7 st, 2dc in the 8th one] x 11. Finish row by working 1 dc in the last 7 st. Sl st in the 1st st of the row. (108)

Round 11: Ch 2, turn work and work one more dc in the same st. [Work 1 dc in the next 8 st, 2dc in the 9th one] x 11. Finish row by working 1 dc in the last 8 st. Sl st in the 1st st of the row. (120)

Round 12: Ch 2, turn work and work one more dc in the same st. [Work 1 dc in the next 9 st, 2dc in the 10th one] x 11. Finish row by working 1 dc in the last 9 st. Sl st in the 1st st of the row. (132)

Round 13: Ch 2, turn work and work one more dc in the same st. [Work 1 dc in the next 10 st, 2dc in the 11th one] x 11. Finish row by working 1 dc in the last 10 st. Sl st in the 1st st of the row. (144)

Round 14: Ch 2, turn work and work one more dc in the same st. [Work 1 dc in the next 11 st, 2dc in the 12th one] x 11. Finish row by working 1 dc in the last 11 st. Sl st in the 1st st of the row. (156)

Round 15: In this row we're going to create the sleeve openings, so we aren't going to work any increases. The end st count, along with the ch will be 156 again.

Ch 2 and turn work. Starting from the next st, work 25 dc. (this is the top of your vest)

Ch 19, sk 19 st and work 1 dc in the 20th st (1st sleeve opening).

Work 1 dc in the next 65 st (this is the bottom of your vest).

Ch 19, sk 19 st and work 1 dc in the 20th (2nd sleeve opening).

Finish by working 1 dc in the last 25 st. (this is the top of your vest)



Round 16: Note - From this row on, we're going to work increases again. In the st count of this row, the ch that we have worked for the sleeve openings count as st as well, so we work in the ch and not under them.

Ch 2, turn work and work one more dc in the same st. [Work 1 dc in the next 12 st, 2dc in the 13th one] x 11. Finish row by working 1 dc in the last 12 st. Sl st in the 1st st of the row. (168)

Round 17: Ch 2, turn work and work one more dc in the same st. [Work 1 dc in the next 13 st, 2dc in the 14th one] x 11. Finish row by working 1 dc in the last 13 st. Sl st in the 1st st of the row. (180)

Round 18: Ch 2, turn work and work one more dc in the same st. [Work 1 dc in the next 14 st, 2dc in the 15th one] x 11. Finish row by working 1 dc in the last 14 st. Sl st in the 1st st of the row. (192)

Round 19: Ch 2, turn work and work one more dc in the same st. [Work 1 dc in the next 15 st, 2dc in the 16th one] x 11. Finish row by working 1 dc in the last 15 st. Sl st in the 1st st of the row. (204)

Round 20: Ch 2, turn work and work one more dc in the same st. [Work 1 dc in the next 16 st, 2dc in the 17th one] x 11. Finish row by working 1 dc in the last 16 st. Sl st in the 1st st of the row. (216)

Round 21: Ch 2, turn work and work one more dc in the same st. [Work 1 dc in the next 17 st, 2dc in the 18th one] x 11. Finish row by working 1 dc in the last 17 st. Sl st in the 1st st of the row. (228)

Round 22: Ch 2, turn work and work one more dc in the same st. [Work 1 dc in the next 18 st, 2dc in the 19th one] x 11. Finish row by working 1 dc in the last 18 st. Sl st in the 1st st of the row. (240)

Round 23: Ch 2, turn work and work one more dc in the same st. [Work 1 dc in the next 19 st, 2dc in the 20th one] x 11. Finish row by working 1 dc in the last 19 st. Sl st in the 1st st of the row. (252)

Round 24: Ch 2, turn work and work one more dc in the same st. [Work 1 dc in the next 20 st, 2dc in the 21st one] x 11. Finish row by working 1 dc in the last 20 st. Sl st in the 1st st of the row. (264)

Round 25: Ch 2, turn work and work one more dc in the same st. [Work 1 dc in the next 21 st, 2dc in the 22nd one] x 11. Finish row by working 1 dc in the last 21 st. Sl st in the 1st st of the row. (276)

Round 26: Ch 2, turn work and work one more dc in the same st. [Work 1 dc in the next 22 st, 2dc in the 23rd one] x 11. Finish row by working 1 dc in the last 22 st. Sl st in the 1st st of the row. (288)

Round 27: Ch 2, turn work and work one more dc in the same st. [Work 1 dc in the next 23 st, 2dc in the 24th one] x 11. Finish row by working 1 dc in the last 23 st. Sl st in the 1st st of the row. (300)

Round 28: Ch 2, turn work and work one more dc in the same st. [Work 1 dc in the next 24 st, 2dc in the 25th one] x 11. Finish row by working 1 dc in the last 24 st. Sl st in the 1st st of the row. (312)

Round 29: Ch 2, turn work and work one more dc in the same st. [Work 1 dc in the next 25 st, 2dc in the 26th one] x 11. Finish row by working 1 dc in the last 25 st. Sl st in the 1st st of the row. (324)

Round 30: Ch 2, turn work and work one more dc in the same st. [Work 1 dc in the next 26 st, 2dc in the 27th one] x 11. Finish row by working 1 dc in the last 26 st. Sl st in the 1st st of the row. (336)

Round 31: Ch 2, turn work and work one more dc in the same st. [Work 1 dc in the next 27 st, 2dc in the 28th one] x 11. Finish row by working 1 dc in the last 27 st. Sl st in the 1st st of the row. (348)

Round 32: Ch 2, turn work and work one more dc in the same st. [Work 1 dc in the next 28 st, 2dc in the 29th one] x 11. Finish row by working 1 dc in the last 28 st. Sl st in the 1st st of the row. (360)

Round 33: Ch 2, turn work and work one more dc in the same st. [Work 1 dc in the next 29 st, 2dc in the 30th one] x 11. Finish row by working 1 dc in the last 29 st. Sl st in the 1st st of the row. (372)

Round 34: Ch 2, turn work and work one more dc in the same st. [Work 1 dc in the next 30 st, 2dc in the 31st one] x 11. Finish row by working 1 dc in the last 30 st. Sl st in the 1st st of the row. (384)

Round 35: Ch 2, turn work and work one more dc in the same st. [Work 1 dc in the next 31 st, 2dc in the 32nd one] x 11. Finish row by working 1 dc in the last 31 st. Sl st in the 1st st of the row. (396)

Round 36: Ch 2, turn work and work one more dc in the same st. [Work 1 dc in the next 32 st, 2dc in the 33rd one] x 11. Finish row by working 1 dc in the last 32 st. Sl st in the 1st st of the row. (408)

The Ribbing:

Round 37: *(Trust me, it's easier to crochet than what it looks when written out)* Ch 3 and turn work. Work [1 fptr in the next st, then 1 bptr in the next one] x 16. For the increase, which will be worked in the next st, the 34th one, work 1 fptr and 1 dc in the same st (see photo below how to work the increase correctly).

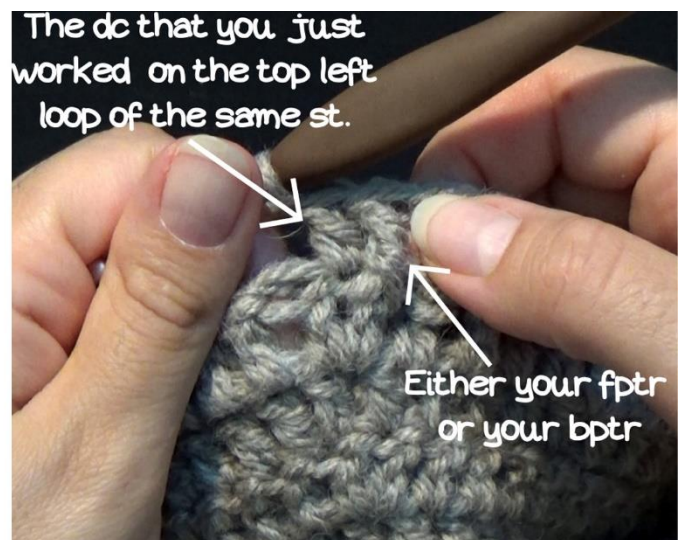
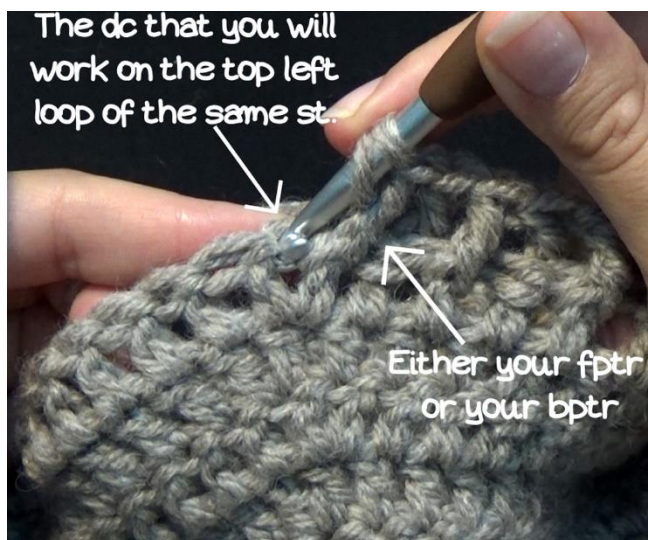

* Continue by working [1 fptr in the next st, then 1 bptr in the next one] x 16, then 1 fptr in the next st. For the increase, which will be worked in the next st, the 34th one, work 1 bptr and 1 dc in the same st. Continue by working [1 bptr in the next st, then 1 fptr in the next one] x 16, then 1 bptr in the next st. For the increase, which will be worked in the next st, the 34th one, work 1 fptr and 1 dc in the same st **.

Work from * to ** 4 more times.

Finish the row by working [1 fptr in the next st, then 1 bptr in the next one] x 16, then 1 fptr in the next st. For the increase, which will be worked in the next st, the 34th one, work 1 bptr and 1 dc in the same st. Sl st in the 1st st of the row. (420)

Round 38: Ch 2 and turn work. [work 1 fpdc in the next st and then 1 bpdc in the next one] x 234. Sl st in the 1st st of the row. (420)

And your cardigan is complete!! Ch 1, cut the yarn and fasten off. Weave in all of your ends.

Size	Shoulder to Shoulder	Diameter of Circle in Row 15	Diameter of Cardigan
Medium	39.5 cm (or 15.5 in)	44.5 cm (or 17.5 in)	118 cm or 46.5 in

Start with a Magic Circle or Ch 4 and sl st in 1st chain to form ring.

Round 1: If starting with a magic circle, ch 2. If starting with the ch ring, chain 3. In the center of your ring, work 11 dc. Sl st in the 1st of the row (*see above in the “important tips” section how to work your sl st*). (12)

Round 2: Ch 2, turn work and work one more dc in the same st. [Work 2 dc in every stitch all around] x 11. Sl st in the 1st st of the row. (24)

Round 3: Ch 2, turn work and work one more dc in the same st. [Work 1 dc in next st, 2dc in the next one] x 11. Finish row by working 1 dc in the last st. Sl st in the 1st st of the row. (36)

Round 4: Ch 2, turn work and work one more dc in the same st. [Work 1 dc in the next 2 st, 2dc in the 3rd one] x 11. Finish row by working 1 dc in the last 2 st. Sl st in the 1st st of the row. (48)

Round 5: Ch 2, turn work and work one more dc in the same st. [Work 1 dc in the next 3 st, 2dc in the 4th one] x 11. Finish row by working 1 dc in the last 3 st. Sl st in the 1st st of the row. (60)

Round 6: Ch 2, turn work and work one more dc in the same st. [Work 1 dc in the next 4 st, 2dc in the 5th one] x 11. Finish row by working 1 dc in the last 4 st. Sl st in the 1st st of the row. (72)

Round 7: Ch 2, turn work and work one more dc in the same st. [Work 1 dc in the next 5 st, 2dc in the 6th one] x 11. Finish row by working 1 dc in the last 5 st. Sl st in the 1st st of the row. (84)

Round 8: Ch 2, and turn work. Starting from the next st, work 1 dc all around. Sl st in the 1st st of the row. (*in this row, we don't work any increases because the project has started to get a little wavy*). (84)

Round 9: Ch 2, turn work and work one more dc in the same st. [Work 1 dc in the next 6 st, 2dc in the 7th one] x 11. Finish row by working 1 dc in the last 6 st. Sl st in the 1st st of the row. (96)

Round 10: Ch 2, turn work and work one more dc in the same st. [Work 1 dc in the next 7 st, 2dc in the 8th one] x 11. Finish row by working 1 dc in the last 7 st. Sl st in the 1st st of the row. (108)

Round 11: Ch 2, turn work and work one more dc in the same st. [Work 1 dc in the next 8 st, 2dc in the 9th one] x 11. Finish row by working 1 dc in the last 8 st. Sl st in the 1st st of the row. (120)

Round 12: Ch 2, turn work and work one more dc in the same st. [Work 1 dc in the next 9 st, 2dc in the 10th one] x 11. Finish row by working 1 dc in the last 9 st. Sl st in the 1st st of the row. (132)

Round 13: Ch 2, turn work and work one more dc in the same st. [Work 1 dc in the next 10 st, 2dc in the 11th one] x 11. Finish row by working 1 dc in the last 10 st. Sl st in the 1st st of the row. (144)

Round 14: Ch 2, turn work and work one more dc in the same st. [Work 1 dc in the next 11 st, 2dc in the 12th one] x 11. Finish row by working 1 dc in the last 11 st. Sl st in the 1st st of the row. (156)

Round 15: Ch 2, turn work and work one more dc in the same st. [Work 1 dc in the next 12 st, 2dc in the 13th one] x 11. Finish row by working 1 dc in the last 12 st. Sl st in the 1st st of the row. (168)

Round 16: In this row we're going to create the sleeve openings, so we aren't going to work any increases. The end st count, along with the ch will be 168 again.

Ch 2 and turn work. Starting from the next st, work 27 dc. (this is the top of your vest)

Ch 21, sk 21 st and work 1 dc in the 22nd st (1st sleeve opening).

Work 1 dc in the next 69 st (this is the bottom of your vest).

Ch 21, sk 21 st and work 1 dc in the 22nd (2nd sleeve opening).

Finish by working 1 dc in the last 27 st. (this is the top of your vest).



Round 17: *Note - From this row on, we're going to work increases again. In the st count of this row, the ch that we have worked for the sleeve openings count as st as well, so we work in the ch and not under them.*

Ch 2, turn work and work one more dc in the same st. [Work 1 dc in the next 13 st, 2dc in the 14th one] x 11. Finish row by working 1 dc in the last 13 st. Sl st in the 1st st of the row. (180)

Round 18: Ch 2, turn work and work one more dc in the same st. [Work 1 dc in the next 14 st, 2dc in the 15th one] x 11. Finish row by working 1 dc in the last 14 st. Sl st in the 1st st of the row. (192)

Round 19: Ch 2, turn work and work one more dc in the same st. [Work 1 dc in the next 15 st, 2dc in the 16th one] x 11. Finish row by working 1 dc in the last 15 st. Sl st in the 1st st of the row. (204)

Round 20: Ch 2, turn work and work one more dc in the same st. [Work 1 dc in the next 16 st, 2dc in the 17th one] x 11. Finish row by working 1 dc in the last 16 st. Sl st in the 1st st of the row. (216)

Round 21: Ch 2, turn work and work one more dc in the same st. [Work 1 dc in the next 17 st, 2dc in the 18th one] x 11. Finish row by working 1 dc in the last 17 st. Sl st in the 1st st of the row. (228)

Round 22: Ch 2, turn work and work one more dc in the same st. [Work 1 dc in the next 18 st, 2dc in the 19th one] x 11. Finish row by working 1 dc in the last 18 st. Sl st in the 1st st of the row. (240)

Round 23: Ch 2, turn work and work one more dc in the same st. [Work 1 dc in the next 19 st, 2dc in the 20th one] x 11. Finish row by working 1 dc in the last 19 st. Sl st in the 1st st of the row. (252)

Round 24: Ch 2, turn work and work one more dc in the same st. [Work 1 dc in the next 20 st, 2dc in the 21st one] x 11. Finish row by working 1 dc in the last 20 st. Sl st in the 1st st of the row. (264)

Round 25: Ch 2, turn work and work one more dc in the same st. [Work 1 dc in the next 21 st, 2dc in the 22nd one] x 11. Finish row by working 1 dc in the last 21 st. Sl st in the 1st st of the row. (276)

Round 26: Ch 2, turn work and work one more dc in the same st. [Work 1 dc in the next 22 st, 2dc in the 23rd one] x 11. Finish row by working 1 dc in the last 22 st. Sl st in the 1st st of the row. (288)

Round 27: Ch 2, turn work and work one more dc in the same st. [Work 1 dc in the next 23 st, 2dc in the 24th one] x 11. Finish row by working 1 dc in the last 23 st. Sl st in the 1st st of the row. (300)

Round 28: Ch 2, turn work and work one more dc in the same st. [Work 1 dc in the next 24 st, 2dc in the 25th one] x 11. Finish row by working 1 dc in the last 24 st. Sl st in the 1st st of the row. (312)

Round 29: Ch 2, turn work and work one more dc in the same st. [Work 1 dc in the next 25 st, 2dc in the 26th one] x 11. Finish row by working 1 dc in the last 25 st. Sl st in the 1st st of the row. (324)

Round 30: Ch 2, turn work and work one more dc in the same st. [Work 1 dc in the next 26 st, 2dc in the 27th one] x 11. Finish row by working 1 dc in the last 26 st. Sl st in the 1st st of the row. (336)

Round 31: Ch 2, turn work and work one more dc in the same st. [Work 1 dc in the next 27 st, 2dc in the 28th one] x 11. Finish row by working 1 dc in the last 27 st. Sl st in the 1st st of the row. (348)

Round 32: Ch 2, turn work and work one more dc in the same st. [Work 1 dc in the next 28 st, 2dc in the 29th one] x 11. Finish row by working 1 dc in the last 28 st. Sl st in the 1st st of the row. (360)

Round 33: Ch 2, turn work and work one more dc in the same st. [Work 1 dc in the next 29 st, 2dc in the 30th one] x 11. Finish row by working 1 dc in the last 29 st. Sl st in the 1st st of the row. (372)

Round 34: Ch 2, turn work and work one more dc in the same st. [Work 1 dc in the next 30 st, 2dc in the 31st one] x 11. Finish row by working 1 dc in the last 30 st. Sl st in the 1st st of the row. (384)

Round 35: Ch 2, turn work and work one more dc in the same st. [Work 1 dc in the next 31 st, 2dc in the 32nd one] x 11. Finish row by working 1 dc in the last 31 st. Sl st in the 1st st of the row. (396)

Round 36: Ch 2, turn work and work one more dc in the same st. [Work 1 dc in the next 32 st, 2dc in the 33rd one] x 11. Finish row by working 1 dc in the last 32 st. Sl st in the 1st st of the row. (408)

Round 37: Ch 2, turn work and work one more dc in the same st. [Work 1 dc in the next 33 st, 2dc in the 34th one] x 11. Finish row by working 1 dc in the last 33 st. Sl st in the 1st st of the row. (420)

Round 38: Ch 2, turn work and work one more dc in the same st. [Work 1 dc in the next 34 st, 2dc in the 35th one] x 11. Finish row by working 1 dc in the last 34 st. Sl st in the 1st st of the row. (432)

Round 39: Ch 2, turn work and work one more dc in the same st. [Work 1 dc in the next 35 st, 2dc in the 36th one] x 11. Finish row by working 1 dc in the last 35 st. Sl st in the 1st st of the row. (444)

Round 40: Ch 2, turn work and work one more dc in the same st. [Work 1 dc in the next 36 st, 2dc in the 37th one] x 11. Finish row by working 1 dc in the last 36 st. Sl st in the 1st st of the row. (456)

The Ribbing:

Round 41: *(Trust me, it's easier to crochet than what it looks when written out)* Ch 3 and turn work. Work [1 fptr in the next st, then 1 bptr in the next one] x 18. For the increase, which will be worked in the next st, the 38th one, work 1 fptr and 1 dc in the same st (see photo below how to work the increase correctly).

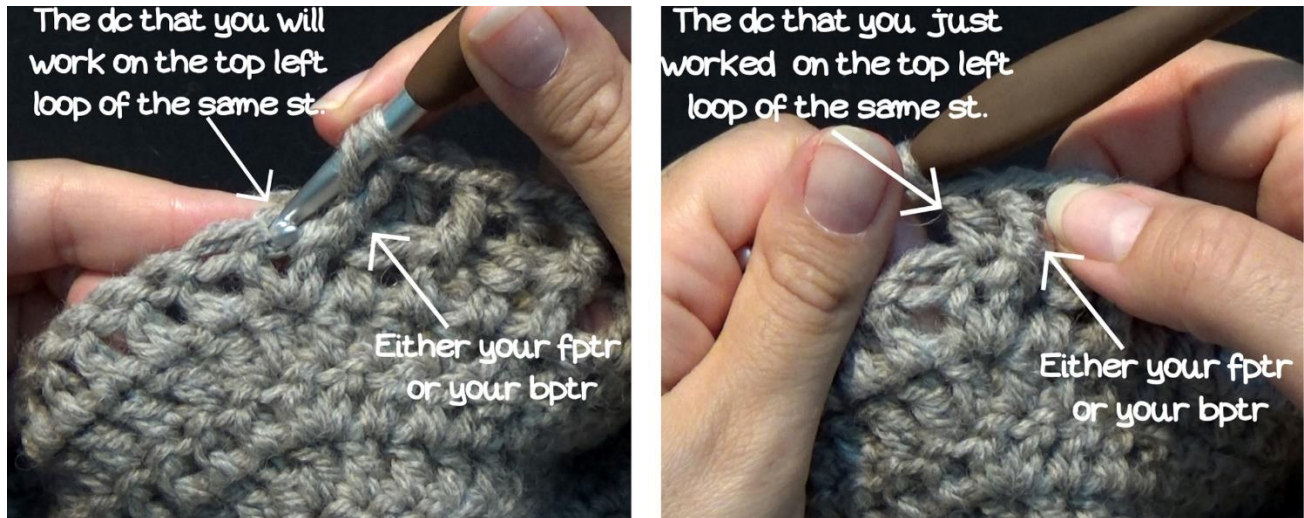

* Continue by working [1 fptr in the next st, then 1 bptr in the next one] x 18, then 1 fptr in the next st. For the increase, which will be worked in the next st, the 38th one, work 1 bptr and 1 dc in the same st. Continue by working [1 bptr in the next st, then 1 fptr in the next one] x 18, then 1 bptr in the next st. For the increase, which will be worked in the next st, the 38th one, work 1 fptr and 1 dc in the same st **.

Work from * to ** 4 more times.

Finish the row by working [1 fptr in the next st, then 1 bptr in the next one] x 18, then 1 fptr in the next st. For the increase, which will be worked in the next st, the 38th one, work 1 bptr and 1 dc in the same st. Sl st in the 1st st of the row. (468)

Round 42: Ch 2 and turn work. [work 1 fpdc in the next st and then 1 bpdc in the next one] x 234. Sl st in the 1st st of the row. (468)

And your cardigan is complete!! Ch 1, cut the yarn and fasten off. Weave in all of your ends.

Size	Shoulder to Shoulder	Diameter of Circle in Row 16	Diameter of Cardigan
Large	42 cm (or 16.5 in)	47.5 cm (or 18.7 in)	125 (or 49.2 in)

Start with a Magic Circle or Ch 4 and sl st in 1st chain to form ring.

Round 1: If starting with a magic circle, ch 2. If starting with the ch ring, chain 3. In the center of your ring, work 11 dc. Sl st in the 1st of the row (*see above in the “important tips” section how to work your sl st*). (12)

Round 2: Ch 2, turn work and work one more dc in the same st. [Work 2 dc in every stitch all around] x 11. Sl st in the 1st st of the row. (24)

Round 3: Ch 2, turn work and work one more dc in the same st. [Work 1 dc in next st, 2dc in the next one] x 11. Finish row by working 1 dc in the last st. Sl st in the 1st st of the row. (36)

Round 4: Ch 2, turn work and work one more dc in the same st. [Work 1 dc in the next 2 st, 2dc in the 3rd one] x 11. Finish row by working 1 dc in the last 2 st. Sl st in the 1st st of the row. (48)

Round 5: Ch 2, turn work and work one more dc in the same st. [Work 1 dc in the next 3 st, 2dc in the 4th one] x 11. Finish row by working 1 dc in the last 3 st. Sl st in the 1st st of the row. (60)

Round 6: Ch 2, turn work and work one more dc in the same st. [Work 1 dc in the next 4 st, 2dc in the 5th one] x 11. Finish row by working 1 dc in the last 4 st. Sl st in the 1st st of the row. (72)

Round 7: Ch 2, turn work and work one more dc in the same st. [Work 1 dc in the next 5 st, 2dc in the 6th one] x 11. Finish row by working 1 dc in the last 5 st. Sl st in the 1st st of the row. (84)

Round 8: Ch 2 and turn work. Starting from the next st, work 1 dc all around. Sl st in the 1st st of the row. (*in this row, we don't work any increases because the project has started to get a little wavy*). (84)

Round 9: Ch 2, turn work and work one more dc in the same st. [Work 1 dc in the next 6 st, 2dc in the 7th one] x 11. Finish row by working 1 dc in the last 6 st. Sl st in the 1st st of the row. (96)

Round 10: Ch 2, turn work and work one more dc in the same st. [Work 1 dc in the next 7 st, 2dc in the 8th one] x 11. Finish row by working 1 dc in the last 7 st. Sl st in the 1st st of the row. (108)

Round 11: Ch 2, turn work and work one more dc in the same st. [Work 1 dc in the next 8 st, 2dc in the 9th one] x 11. Finish row by working 1 dc in the last 8 st. Sl st in the 1st st of the row. (120)

Round 12: Ch 2, turn work and work one more dc in the same st. [Work 1 dc in the next 9 st, 2dc in the 10th one] x 11. Finish row by working 1 dc in the last 9 st. Sl st in the 1st st of the row. (132)

Round 13: Ch 2, turn work and work one more dc in the same st. [Work 1 dc in the next 10 st, 2dc in the 11th one] x 11. Finish row by working 1 dc in the last 10 st. Sl st in the 1st st of the row. (144)

Round 14: Ch 2, turn work and work one more dc in the same st. [Work 1 dc in the next 11 st, 2dc in the 12th one] x 11. Finish row by working 1 dc in the last 11 st. Sl st in the 1st st of the row. (156)

Round 15: Ch 2, turn work and work one more dc in the same st. [Work 1 dc in the next 12 st, 2dc in the 13th one] x 11. Finish row by working 1 dc in the last 12 st. Sl st in the 1st st of the row. (168)

Round 16: Ch 2, turn work and work one more dc in the same st. [Work 1 dc in the next 13 st, 2dc in the 14th one] x 11. Finish row by working 1 dc in the last 13 st. Sl st in the 1st st of the row. (180)

Round 17: In this row we're going to create the sleeve openings, so we aren't going to work any increases. The end st count, along with the ch will be 180 again.

Ch 2 and turn work. Starting from the next st, work 29 dc. (this is the top of your vest)

Ch 23, sk 23 st and work 1 dc in the 24th st (1st sleeve opening).

Work 1 dc in the next 73 st (this is the bottom of your vest).

Ch 23, sk 23 st and work 1 dc in the 24th (2nd sleeve opening).

Finish by working 1 dc in the last 29 st. (this is the top of your vest).



Round 18: Note - From this row on, we're going to work increases again. In the st count of this row, the ch that we have worked for the sleeve openings count as st as well, so we work in the ch and not under them.

Ch 2, turn work and work one more dc in the same st. [Work 1 dc in the next 14 st, 2dc in the 15th one] x 11. Finish row by working 1 dc in the last 14 st. Sl st in the 1st st of the row. (192)

Round 19: Ch 2, turn work and work one more dc in the same st. [Work 1 dc in the next 15 st, 2dc in the 16th one] x 11. Finish row by working 1 dc in the last 15 st. Sl st in the 1st st of the row. (204)

Round 20: Ch 2, turn work and work one more dc in the same st. [Work 1 dc in the next 16 st, 2dc in the 17th one] x 11. Finish row by working 1 dc in the last 16 st. Sl st in the 1st st of the row. (216)

Round 21: Ch 2, turn work and work one more dc in the same st. [Work 1 dc in the next 17 st, 2dc in the 18th one] x 11. Finish row by working 1 dc in the last 17 st. Sl st in the 1st st of the row. (228)

Round 22: Ch 2, turn work and work one more dc in the same st. [Work 1 dc in the next 18 st, 2dc in the 19th one] x 11. Finish row by working 1 dc in the last 18 st. Sl st in the 1st st of the row. (240)

Round 23: Ch 2, turn work and work one more dc in the same st. [Work 1 dc in the next 19 st, 2dc in the 20th one] x 11. Finish row by working 1 dc in the last 19 st. Sl st in the 1st st of the row. (252)

Round 24: Ch 2, turn work and work one more dc in the same st. [Work 1 dc in the next 20 st, 2dc in the 21st one] x 11. Finish row by working 1 dc in the last 20 st. Sl st in the 1st st of the row. (264)

Round 25: Ch 2, turn work and work one more dc in the same st. [Work 1 dc in the next 21 st, 2dc in the 22nd one] x 11. Finish row by working 1 dc in the last 21 st. Sl st in the 1st st of the row. (276)

Round 26: Ch 2, turn work and work one more dc in the same st. [Work 1 dc in the next 22 st, 2dc in the 23rd one] x 11. Finish row by working 1 dc in the last 22 st. Sl st in the 1st st of the row. (288)

Round 27: Ch 2, turn work and work one more dc in the same st. [Work 1 dc in the next 23 st, 2dc in the 24th one] x 11. Finish row by working 1 dc in the last 23 st. Sl st in the 1st st of the row. (300)

Round 28: Ch 2, turn work and work one more dc in the same st. [Work 1 dc in the next 24 st, 2dc in the 25th one] x 11. Finish row by working 1 dc in the last 24 st. Sl st in the 1st st of the row. (312)

Round 29: Ch 2, turn work and work one more dc in the same st. [Work 1 dc in the next 25 st, 2dc in the 26th one] x 11. Finish row by working 1 dc in the last 25 st. Sl st in the 1st st of the row. (324)

Round 30: Ch 2, turn work and work one more dc in the same st. [Work 1 dc in the next 26 st, 2dc in the 27th one] x 11. Finish row by working 1 dc in the last 26 st. Sl st in the 1st st of the row. (336)

Round 31: Ch 2, turn work and work one more dc in the same st. [Work 1 dc in the next 27 st, 2dc in the 28th one] x 11. Finish row by working 1 dc in the last 27 st. Sl st in the 1st st of the row. (348)

Round 32: Ch 2, turn work and work one more dc in the same st. [Work 1 dc in the next 28 st, 2dc in the 29th one] x 11. Finish row by working 1 dc in the last 28 st. Sl st in the 1st st of the row. (360)

Round 33: Ch 2, turn work and work one more dc in the same st. [Work 1 dc in the next 29 st, 2dc in the 30th one] x 11. Finish row by working 1 dc in the last 29 st. Sl st in the 1st st of the row. (372)

Round 34: Ch 2, turn work and work one more dc in the same st. [Work 1 dc in the next 30 st, 2dc in the 31st one] x 11. Finish row by working 1 dc in the last 30 st. Sl st in the 1st st of the row. (384)

Round 35: Ch 2, turn work and work one more dc in the same st. [Work 1 dc in the next 31 st, 2dc in the 32nd one] x 11. Finish row by working 1 dc in the last 31 st. Sl st in the 1st st of the row. (396)

Round 36: Ch 2, turn work and work one more dc in the same st. [Work 1 dc in the next 32 st, 2dc in the 33rd one] x 11. Finish row by working 1 dc in the last 32 st. Sl st in the 1st st of the row. (408)

Round 37: Ch 2, turn work and work one more dc in the same st. [Work 1 dc in the next 33 st, 2dc in the 34th one] x 11. Finish row by working 1 dc in the last 33 st. Sl st in the 1st st of the row. (420)

Round 38: Ch 2, turn work and work one more dc in the same st. [Work 1 dc in the next 34 st, 2dc in the 35th one] x 11. Finish row by working 1 dc in the last 34 st. Sl st in the 1st st of the row. (432)

Round 39: Ch 2, turn work and work one more dc in the same st. [Work 1 dc in the next 35 st, 2dc in the 36th one] x 11. Finish row by working 1 dc in the last 35 st. Sl st in the 1st st of the row. (444)

Round 40: Ch 2, turn work and work one more dc in the same st. [Work 1 dc in the next 36 st, 2dc in the 37th one] x 11. Finish row by working 1 dc in the last 36 st. Sl st in the 1st st of the row. (456)

Round 41: Ch 2, turn work and work one more dc in the same st. [Work 1 dc in the next 37 st, 2dc in the 38th one] x 11. Finish row by working 1 dc in the last 37 st. Sl st in the 1st st of the row. (468)

Round 42: Ch 2, turn work and work one more dc in the same st. [Work 1 dc in the next 38 st, 2dc in the 39th one] x 11. Finish row by working 1 dc in the last 38 st. Sl st in the 1st st of the row. (480)

The Ribbing:

Round 43: *(Trust me, it's easier to crochet than what it looks when written out)* Ch 3 and turn work. Work [1 fptr in the next st, then 1 bptr in the next one] x 19. For the increase, which will be worked in the next st, the 40th one, work 1 fptr and 1 dc in the same st (see photo below how to work the increase correctly).

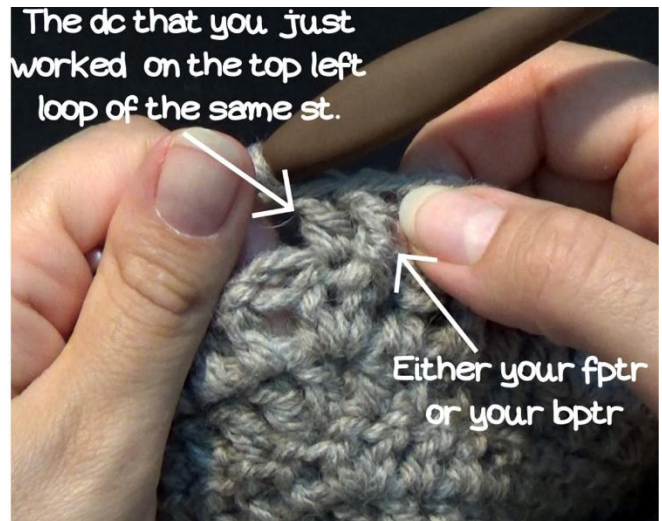

* Continue by working [1 fptr in the next st, then 1 bptr in the next one] x 19, then 1 fptr in the next st. For the increase, which will be worked in the next st, the 40th one, work 1 bptr and 1 dc in the same st. Continue by working [1 bptr in the next st, then 1 fptr in the next one] x 19, then 1 bptr in the next st. For the increase, which will be worked in the next st, the 40th one, work 1 fptr and 1 dc in the same st **.

Work from * to ** 4 more times.

Finish the row by working [1 fptr in the next st, then 1 bptr in the next one] x 19, then 1 fptr in the next st. For the increase, which will be worked in the next st, the 40th one, work 1 bptr and 1 dc in the same st. Sl st in the 1st st of the row. (492)

Round 44: Ch 2 and turn work. [work 1 fpdc in the next st and then 1 bpdc in the next one] x 246. Sl st in the 1st st of the row. (492)

And your cardigan is complete!! Ch 1, cut the yarn and fasten off. Weave in all of your ends.

Size	Shoulder to Shoulder	Diameter of Circle in Row 17	Diameter of Cardigan
X-Large	44.5 cm (or 17.5 in)	51 cm (or 20 in)	137 cm (or 54 in)

Start with a Magic Circle or Ch 4 and sl st in 1st chain to form ring.

Round 1: If starting with a magic circle, ch 2. If starting with the ch ring, chain 3. In the center of your ring, work 11 dc. Sl st in the 1st of the row (*see above in the “important tips” section how to work your sl st*). (12)

Round 2: Ch 2, turn work and work one more dc in the same st. [Work 2 dc in every stitch all around] x 11. Sl st in the 1st st of the row. (24)

Round 3: Ch 2, turn work and work one more dc in the same st. [Work 1 dc in next st, 2dc in the next one] x 11. Finish row by working 1 dc in the last st. Sl st in the 1st st of the row. (36)

Round 4: Ch 2, turn work and work one more dc in the same st. [Work 1 dc in the next 2 st, 2dc in the 3rd one] x 11. Finish row by working 1 dc in the last 2 st. Sl st in the 1st st of the row. (48)

Round 5: Ch 2, turn work and work one more dc in the same st. [Work 1 dc in the next 3 st, 2dc in the 4th one] x 11. Finish row by working 1 dc in the last 3 st. Sl st in the 1st st of the row. (60)

Round 6: Ch 2, turn work and work one more dc in the same st. [Work 1 dc in the next 4 st, 2dc in the 5th one] x 11. Finish row by working 1 dc in the last 4 st. Sl st in the 1st st of the row. (72)

Round 7: Ch 2, turn work and work one more dc in the same st. [Work 1 dc in the next 5 st, 2dc in the 6th one] x 11. Finish row by working 1 dc in the last 5 st. Sl st in the 1st st of the row. (84)

Round 8: Ch 2, turn work. Starting from the next st, work 1 dc all around. Sl st in the 1st st of the row. (*in this row, we don't work any increases because the project has started to get a little wavy*). (84)

Round 9: Ch 2, turn work and work one more dc in the same st. [Work 1 dc in the next 6 st, 2dc in the 7th one] x 11. Finish row by working 1 dc in the last 6 st. Sl st in the 1st st of the row. (96)

Round 10: Ch 2, turn work and work one more dc in the same st. [Work 1 dc in the next 7 st, 2dc in the 8th one] x 11. Finish row by working 1 dc in the last 7 st. Sl st in the 1st st of the row. (108)

Round 11: Ch 2, turn work and work one more dc in the same st. [Work 1 dc in the next 8 st, 2dc in the 9th one] x 11. Finish row by working 1 dc in the last 8 st. Sl st in the 1st st of the row. (120)

Round 12: Ch 2, turn work and work one more dc in the same st. [Work 1 dc in the next 9 st, 2dc in the 10th one] x 11. Finish row by working 1 dc in the last 9 st. Sl st in the 1st st of the row. (132)

Round 13: Ch 2, turn work and work one more dc in the same st. [Work 1 dc in the next 10 st, 2dc in the 11th one] x 11. Finish row by working 1 dc in the last 10 st. Sl st in the 1st st of the row. (144)

Round 14: Ch 2, turn work and work one more dc in the same st. [Work 1 dc in the next 11 st, 2dc in the 12th one] x 11. Finish row by working 1 dc in the last 11 st. Sl st in the 1st st of the row. (156)

Round 15: Ch 2, turn work and work one more dc in the same st. [Work 1 dc in the next 12 st, 2dc in the 13th one] x 11. Finish row by working 1 dc in the last 12 st. Sl st in the 1st st of the row. (168)

Round 16: Ch 2, turn work and work one more dc in the same st. [Work 1 dc in the next 13 st, 2dc in the 14th one] x 11. Finish row by working 1 dc in the last 13 st. Sl st in the 1st st of the row. (180)

Round 17: Ch 2, turn work and work one more dc in the same st. [Work 1 dc in the next 14 st, 2dc in the 15th one] x 11. Finish row by working 1 dc in the last 14 st. Sl st in the 1st st of the row. (192)

Round 18: In this row we're going to create the sleeve openings, so we aren't going to work any increases. The end st count, along with the ch will be 192 again.

Ch 2 and turn work. Starting from the next st, work 31 dc. (this is the top of your vest)

Ch 25, sk 25 st and work 1 dc in the 26th st (1st sleeve opening).

Work 1 dc in the next 77 st (this is the bottom of your vest).

Ch 25, sk 25 st and work 1 dc in the 26th (2nd sleeve opening).

Finish by working 1 dc in the last 31 st. (this is the top of your vest).



Round 19: Note - From this row on, we're going to work increases again. In the st count of this row, the ch that we have worked for the sleeve openings count as st as well, so we work in the ch and not under them.

Ch 2, turn work and work one more dc in the same st. [Work 1 dc in the next 15 st, 2dc in the 16th one] x 11. Finish row by working 1 dc in the last 15 st. Sl st in the 1st st of the row. (204)

Round 20: Ch 2, turn work and work one more dc in the same st. [Work 1 dc in the next 16 st, 2dc in the 17th one] x 11. Finish row by working 1 dc in the last 16 st. Sl st in the 1st st of the row. (216)

Round 21: Ch 2, turn work and work one more dc in the same st. [Work 1 dc in the next 17 st, 2dc in the 18th one] x 11. Finish row by working 1 dc in the last 17 st. Sl st in the 1st st of the row. (228)

Round 22: Ch 2, turn work and work one more dc in the same st. [Work 1 dc in the next 18 st, 2dc in the 19th one] x 11. Finish row by working 1 dc in the last 18 st. Sl st in the 1st st of the row. (240)

Round 23: Ch 2, turn work and work one more dc in the same st. [Work 1 dc in the next 19 st, 2dc in the 20th one] x 11. Finish row by working 1 dc in the last 19 st. Sl st in the 1st st of the row. (252)

Round 24: Ch 2, turn work and work one more dc in the same st. [Work 1 dc in the next 20 st, 2dc in the 21st one] x 11. Finish row by working 1 dc in the last 20 st. Sl st in the 1st st of the row. (264)

Round 25: Ch 2, turn work and work one more dc in the same st. [Work 1 dc in the next 21 st, 2dc in the 22nd one] x 11. Finish row by working 1 dc in the last 21 st. Sl st in the 1st st of the row. (276)

Round 26: Ch 2, turn work and work one more dc in the same st. [Work 1 dc in the next 22 st, 2dc in the 23rd one] x 11. Finish row by working 1 dc in the last 22 st. Sl st in the 1st st of the row. (288)

Round 27: Ch 2, turn work and work one more dc in the same st. [Work 1 dc in the next 23 st, 2dc in the 24th one] x 11. Finish row by working 1 dc in the last 23 st. Sl st in the 1st st of the row. (300)

Round 28: Ch 2, turn work and work one more dc in the same st. [Work 1 dc in the next 24 st, 2dc in the 25th one] x 11. Finish row by working 1 dc in the last 24 st. Sl st in the 1st st of the row. (312)

Round 29: Ch 2, turn work and work one more dc in the same st. [Work 1 dc in the next 25 st, 2dc in the 26th one] x 11. Finish row by working 1 dc in the last 25 st. Sl st in the 1st st of the row. (324)

Round 30: Ch 2, turn work and work one more dc in the same st. [Work 1 dc in the next 26 st, 2dc in the 27th one] x 11. Finish row by working 1 dc in the last 26 st. Sl st in the 1st st of the row. (336)

Round 31: Ch 2, turn work and work one more dc in the same st. [Work 1 dc in the next 27 st, 2dc in the 28th one] x 11. Finish row by working 1 dc in the last 27 st. Sl st in the 1st st of the row. (348)

Round 32: Ch 2, turn work and work one more dc in the same st. [Work 1 dc in the next 28 st, 2dc in the 29th one] x 11. Finish row by working 1 dc in the last 28 st. Sl st in the 1st st of the row. (360)

Round 33: Ch 2, turn work and work one more dc in the same st. [Work 1 dc in the next 29 st, 2dc in the 30th one] x 11. Finish row by working 1 dc in the last 29 st. Sl st in the 1st st of the row. (372)

Round 34: Ch 2, turn work and work one more dc in the same st. [Work 1 dc in the next 30 st, 2dc in the 31st one] x 11. Finish row by working 1 dc in the last 30 st. Sl st in the 1st st of the row. (384)

Round 35: Ch 2, turn work and work one more dc in the same st. [Work 1 dc in the next 31 st, 2dc in the 32nd one] x 11. Finish row by working 1 dc in the last 31 st. Sl st in the 1st st of the row. (396)

Round 36: Ch 2, turn work and work one more dc in the same st. [Work 1 dc in the next 32 st, 2dc in the 33rd one] x 11. Finish row by working 1 dc in the last 32 st. Sl st in the 1st st of the row. (408)

Round 37: Ch 2, turn work and work one more dc in the same st. [Work 1 dc in the next 33 st, 2dc in the 34th one] x 11. Finish row by working 1 dc in the last 33 st. Sl st in the 1st st of the row. (420)

Round 38: Ch 2, turn work and work one more dc in the same st. [Work 1 dc in the next 34 st, 2dc in the 35th one] x 11. Finish row by working 1 dc in the last 34 st. Sl st in the 1st st of the row. (432)

Round 39: Ch 2, turn work and work one more dc in the same st. [Work 1 dc in the next 35 st, 2dc in the 36th one] x 11. Finish row by working 1 dc in the last 35 st. Sl st in the 1st st of the row. (444)

Round 40: Ch 2, turn work and work one more dc in the same st. [Work 1 dc in the next 36 st, 2dc in the 37th one] x 11. Finish row by working 1 dc in the last 36 st. Sl st in the 1st st of the row. (456)

Round 41: Ch 2, turn work and work one more dc in the same st. [Work 1 dc in the next 37 st, 2dc in the 38th one] x 11. Finish row by working 1 dc in the last 37 st. Sl st in the 1st st of the row. (468)

Round 42: Ch 2, turn work and work one more dc in the same st. [Work 1 dc in the next 38 st, 2dc in the 39th one] x 11. Finish row by working 1 dc in the last 38 st. Sl st in the 1st st of the row. (480)

Round 43: Ch 2, turn work and work one more dc in the same st. [Work 1 dc in the next 39 st, 2dc in the 40th one] x 11. Finish row by working 1 dc in the last 39 st. Sl st in the 1st st of the row. (492)

Round 44: Ch 2, turn work and work one more dc in the same st. [Work 1 dc in the next 40 st, 2dc in the 41st one] x 11. Finish row by working 1 dc in the last 40 st. Sl st in the 1st st of the row. (504)

Round 45: Ch 2, turn work and work one more dc in the same st. [Work 1 dc in the next 41 st, 2dc in the 42nd one] x 11. Finish row by working 1 dc in the last 41 st. Sl st in the 1st st of the row. (516)

Round 46: Ch 2, turn work and work one more dc in the same st. [Work 1 dc in the next 42 st, 2dc in the 43rd one] x 11. Finish row by working 1 dc in the last 42 st. Sl st in the 1st st of the row. (528)

The Ribbing:

Round 47: *(Trust me, it's easier to crochet than what it looks when written out)* Ch 3 and turn work. Work [1 fptr in the next st, 1 bptr in the next one] x 21. For the increase, which will be worked in the next st, the 44th one, work 1 fptr and 1 dc in the same st (see photo below how to work the increase correctly).

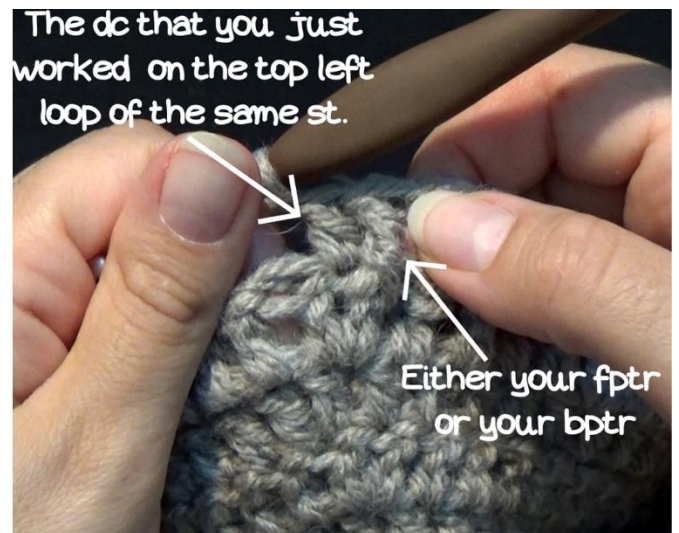

* Continue by working [1 fptr in the next st, then 1 bptr in the next one] x 21, then 1 fptr in the next st. For the increase, which will be worked in the next st, the 44th one, work 1 bptr and 1 dc in the same st. Continue by working [1 bptr in the next st, then 1 fptr in the next one] x 21, then 1 bptr in the next st. For the increase, which will be worked in the next st, the 44th one, work 1 fptr and 1 dc in the same st **.

Work from * to ** 4 more times.

Finish the row by working [1 fptr in the next st, then 1 bptr in the next one] x 21, then 1 fptr in the next st. For the increase, which will be worked in the next st, the 44th one, work 1 bptr and 1 dc in the same st. Sl st in the 1st st of the row. (540)

Round 48: Ch 2 and turn work. [work 1 fpdc in the next st and then 1 bpdc in the next one] x 270. Sl st in the 1st st of the row. (540)

And your cardigan is complete!! Ch 1, cut the yarn and fasten off. Weave in all of your ends.

Size	Shoulder to Shoulder	Diameter of Circle in Row 18	Diameter of Cardigan
2X-Large	45.5 cm (or 18 in)	56 cm (or 22 in)	150 cm (or 59 in)

Start with a Magic Circle or Ch 4 and sl st in 1st chain to form ring.

Round 1: If starting with a magic circle, ch 2. If starting with the ch ring, chain 3. In the center of your ring, work 11 dc. Sl st in the 1st of the row (*see above in the “important tips” section how to work your sl st*). (12)

Round 2: Ch 2, turn work and work one more dc in the same st. [Work 2 dc in every stitch all around] x 11. Sl st in the 1st st of the row. (24)

Round 3: Ch 2, turn work and work one more dc in the same st. [Work 1 dc in next st, 2dc in the next one] x 11. Finish row by working 1 dc in the last st. Sl st in the 1st st of the row. (36)

Round 4: Ch 2, turn work and work one more dc in the same st. [Work 1 dc in the next 2 st, 2dc in the 3rd one] x 11. Finish row by working 1 dc in the last 2 st. Sl st in the 1st st of the row. (48)

Round 5: Ch 2, turn work and work one more dc in the same st. [Work 1 dc in the next 3 st, 2dc in the 4th one] x 11. Finish row by working 1 dc in the last 3 st. Sl st in the 1st st of the row. (60)

Round 6: Ch 2, turn work and work one more dc in the same st. [Work 1 dc in the next 4 st, 2dc in the 5th one] x 11. Finish row by working 1 dc in the last 4 st. Sl st in the 1st st of the row. (72)

Round 7: Ch 2, turn work and work one more dc in the same st. [Work 1 dc in the next 5 st, 2dc in the 6th one] x 11. Finish row by working 1 dc in the last 5 st. Sl st in the 1st st of the row. (84)

Round 8: Ch 2, turn work. Starting from the next st, work 1 dc all around. Sl st in the 1st st of the row. (*in this row, we don't work any increases because the project has started to get a little wavy*). (84)

Round 9: Ch 2, turn work and work one more dc in the same st. [Work 1 dc in the next 6 st, 2dc in the 7th one] x 11. Finish row by working 1 dc in the last 6 st. Sl st in the 1st st of the row. (96)

Round 10: Ch 2, turn work and work one more dc in the same st. [Work 1 dc in the next 7 st, 2dc in the 8th one] x 11. Finish row by working 1 dc in the last 7 st. Sl st in the 1st st of the row. (108)

Round 11: Ch 2, turn work and work one more dc in the same st. [Work 1 dc in the next 8 st, 2dc in the 9th one] x 11. Finish row by working 1 dc in the last 8 st. Sl st in the 1st st of the row. (120)

Round 12: Ch 2, turn work and work one more dc in the same st. [Work 1 dc in the next 9 st, 2dc in the 10th one] x 11. Finish row by working 1 dc in the last 9 st. Sl st in the 1st st of the row. (132)

Round 13: Ch 2, turn work and work one more dc in the same st. [Work 1 dc in the next 10 st, 2dc in the 11th one] x 11. Finish row by working 1 dc in the last 10 st. Sl st in the 1st st of the row. (144)

Round 14: Ch 2, turn work and work one more dc in the same st. [Work 1 dc in the next 11 st, 2dc in the 12th one] x 11. Finish row by working 1 dc in the last 11 st. Sl st in the 1st st of the row. (156)

Round 15: Ch 2, turn work and work one more dc in the same st. [Work 1 dc in the next 12 st, 2dc in the 13th one] x 11. Finish row by working 1 dc in the last 12 st. Sl st in the 1st st of the row. (168)

Round 16: Ch 2, turn work and work one more dc in the same st. [Work 1 dc in the next 13 st, 2dc in the 14th one] x 11. Finish row by working 1 dc in the last 13 st. Sl st in the 1st st of the row. (180)

Round 17: Ch 2, turn work and work one more dc in the same st. [Work 1 dc in the next 14 st, 2dc in the 15th one] x 11. Finish row by working 1 dc in the last 14 st. Sl st in the 1st st of the row. (192)

Round 18: Ch 2, turn work and work one more dc in the same st. [Work 1 dc in the next 15 st, 2dc in the 16th one] x 11. Finish row by working 1 dc in the last 15 st. Sl st in the 1st st of the row. (204)

Round 19: In this row we're going to create the sleeve openings, so we aren't going to work any increases. The end st count, along with the ch will be 204 again.

Ch 2 and turn work. Starting from the next st, work 33 dc. (this is the top of your vest)

Ch 27, sk 27 st and work 1 dc in the 28th st (1st sleeve opening).

Work 1 dc in the next 81 st (this is the bottom of your vest).

Ch 27, sk 27 st and work 1 dc in the 28th (2nd sleeve opening).

Finish by working 1 dc in the last 33 st. (this is the top of your vest).



Round 20: Note - *From this row on, we're going to work increases again. In the st count of this row, the ch that we have worked for the sleeve openings count as st as well, so we work in the ch and not under them.*

Ch 2, turn work and work one more dc in the same st. [Work 1 dc in the next 16 st, 2dc in the 17th one] x 11. Finish row by working 1 dc in the last 15 st. Sl st in the 1st st of the row. (216)

Round 21: Ch 2, turn work and work one more dc in the same st. [Work 1 dc in the next 17 st, 2dc in the 18th one] x 11. Sl st in the 1st st of the row. (228)

Round 22: Ch 2, turn work and work one more dc in the same st. [Work 1 dc in the next 18 st, 2dc in the 19th one] x 11. Finish row by working 1 dc in the last 18 st. Sl st in the 1st st of the row. (240)

Round 23: Ch 2, turn work and work one more dc in the same st. [Work 1 dc in the next 19 st, 2dc in the 20th one] x 11. Finish row by working 1 dc in the last 19 st. Sl st in the 1st st of the row. (252)

Round 24: Ch 2, turn work and work one more dc in the same st. [Work 1 dc in the next 20 st, 2dc in the 21st one] x 11. Finish row by working 1 dc in the last 20 st. Sl st in the 1st st of the row. (264)

Round 25: Ch 2, turn work and work one more dc in the same st. [Work 1 dc in the next 21 st, 2dc in the 22nd one] x 11. Finish row by working 1 dc in the last 21 st. Sl st in the 1st st of the row. (276)

Round 26: Ch 2, turn work and work one more dc in the same st. [Work 1 dc in the next 22 st, 2dc in the 23rd one] x 11. Finish row by working 1 dc in the last 22 st. Sl st in the 1st st of the row. (288)

Round 27: Ch 2, turn work and work one more dc in the same st. [Work 1 dc in the next 23 st, 2dc in the 24th one] x 11. Finish row by working 1 dc in the last 23 st. Sl st in the 1st st of the row. (300)

Round 28: Ch 2, turn work and work one more dc in the same st. [Work 1 dc in the next 24 st, 2dc in the 25th one] x 11. Finish row by working 1 dc in the last 24 st. Sl st in the 1st st of the row. (312)

Round 29: Ch 2, turn work and work one more dc in the same st. [Work 1 dc in the next 25 st, 2dc in the 26th one] x 11. Finish row by working 1 dc in the last 25 st. Sl st in the 1st st of the row. (324)

Round 30: Ch 2, turn work and work one more dc in the same st. [Work 1 dc in the next 26 st, 2dc in the 27th one] x 11. Finish row by working 1 dc in the last 26 st. Sl st in the 1st st of the row. (336)

Round 31: Ch 2, turn work and work one more dc in the same st. [Work 1 dc in the next 27 st, 2dc in the 28th one] x 11. Finish row by working 1 dc in the last 27 st. Sl st in the 1st st of the row. (348)

Round 32: Ch 2, turn work and work one more dc in the same st. [Work 1 dc in the next 28 st, 2dc in the 29th one] x 11. Finish row by working 1 dc in the last 28 st. Sl st in the 1st st of the row. (360)

Round 33: Ch 2, turn work and work one more dc in the same st. [Work 1 dc in the next 29 st, 2dc in the 30th one] x 11. Finish row by working 1 dc in the last 29 st. Sl st in the 1st st of the row. (372)

Round 34: Ch 2, turn work and work one more dc in the same st. [Work 1 dc in the next 30 st, 2dc in the 31st one] x 11. Finish row by working 1 dc in the last 30 st. Sl st in the 1st st of the row. (384)

Round 35: Ch 2, turn work and work one more dc in the same st. [Work 1 dc in the next 31 st, 2dc in the 32nd one] x 11. Finish row by working 1 dc in the last 31 st. Sl st in the 1st st of the row. (396)

Round 36: Ch 2, turn work and work one more dc in the same st. [Work 1 dc in the next 32 st, 2dc in the 33rd one] x 11. Finish row by working 1 dc in the last 32 st. Sl st in the 1st st of the row. (408)

Round 37: Ch 2, turn work and work one more dc in the same st. [Work 1 dc in the next 33 st, 2dc in the 34th one] x 11. Finish row by working 1 dc in the last 33 st. Sl st in the 1st st of the row. (420)

Round 38: Ch 2, turn work and work one more dc in the same st. [Work 1 dc in the next 34 st, 2dc in the 35th one] x 11. Finish row by working 1 dc in the last 34 st. Sl st in the 1st st of the row. (432)

Round 39: Ch 2, turn work and work one more dc in the same st. [Work 1 dc in the next 35 st, 2dc in the 36th one] x 11. Finish row by working 1 dc in the last 35 st. Sl st in the 1st st of the row. (444)

Round 40: Ch 2, turn work and work one more dc in the same st. [Work 1 dc in the next 36 st, 2dc in the 37th one] x 11. Finish row by working 1 dc in the last 36 st. Sl st in the 1st st of the row. (456)

Round 41: Ch 2, turn work and work one more dc in the same st. [Work 1 dc in the next 37 st, 2dc in the 38th one] x 11. Finish row by working 1 dc in the last 37 st. Sl st in the 1st st of the row. (468)

Round 42: Ch 2, turn work and work one more dc in the same st. [Work 1 dc in the next 38 st, 2dc in the 39th one] x 11. Finish row by working 1 dc in the last 38 st. Sl st in the 1st st of the row. (480)

Round 43: Ch 2, turn work and work one more dc in the same st. [Work 1 dc in the next 39 st, 2dc in the 40th one] x 11. Finish row by working 1 dc in the last 39 st. Sl st in the 1st st of the row. (492)

Round 44: Ch 2, turn work and work one more dc in the same st. [Work 1 dc in the next 40 st, 2dc in the 41st one] x 11. Finish row by working 1 dc in the last 40 st. Sl st in the 1st st of the row. (504)

Round 45: Ch 2, turn work and work one more dc in the same st. [Work 1 dc in the next 41 st, 2dc in the 42nd one] x 11. Finish row by working 1 dc in the last 41 st. Sl st in the 1st st of the row. (516)

Round 46: Ch 2, turn work and work one more dc in the same st. [Work 1 dc in the next 42 st, 2dc in the 43rd one] x 11. Finish row by working 1 dc in the last 42 st. Sl st in the 1st st of the row. (528)

Round 47: Ch 2, turn work and work one more dc in the same st. [Work 1 dc in the next 43 st, 2dc in the 44th one] x 11. Finish row by working 1 dc in the last 43 st. Sl st in the 1st st of the row. (540)

Round 48: Ch 2, turn work and work one more dc in the same st. [Work 1 dc in the next 44 st, 2dc in the 45th one] x 11. Finish row by working 1 dc in the last 44 st. Sl st in the 1st st of the row. (552)

Round 49: Ch 2, turn work and work one more dc in the same st. [Work 1 dc in the next 45 st, 2dc in the 46th one] x 11. Finish row by working 1 dc in the last 45 st. Sl st in the 1st st of the row. (564)

Round 50: Ch 2, turn work and work one more dc in the same st. [Work 1 dc in the next 46 st, 2dc in the 47th one] x 11. Finish row by working 1 dc in the last 46 st. Sl st in the 1st st of the row. (576)

The Ribbing:

Round 51: *(Trust me, it's easier to crochet than what it looks when written out)* Ch 3 and turn work. Work [1 fptr in the next st, 1 bptr in the next one] x 23. For the increase, which will be worked in the next st, the 48th one, work 1 fptr and 1 dc in the same st (see photo below how to work the increase correctly).



* Continue by working [1 fptr in the next st, then 1 bptr in the next one] x 23, then 1 fptr in the next st. For the increase, which will be worked in the next st, the 48th one, work 1 bptr and 1 dc in the same st. Continue by working [1 bptr in the next st, then 1 fptr in the next one] x 23, then 1 bptr in the next st. For the increase, which will be worked in the next st, the 48th one, work 1 fptr and 1 dc in the same st **.

Work from * to ** 4 more times.

Finish the row by working [1 fptr in the next st, then 1 bptr in the next one] x 23, then 1 fptr in the next st. For the increase, which will be worked in the next st, the 48th one, work 1 bptr and 1 dc in the same st. Sl st in the 1st st of the row. (588)

Round 52: Ch 2 and turn work. [work 1 fpdc in the next st and then 1 bpdc in the next one] x 294. Sl st in the 1st st of the row. (588)

And your cardigan is complete!! Ch 1, cut the yarn and fasten off. Weave in all of your ends.

Size	Shoulder to Shoulder	Diameter of Circle in Row 19	Diameter of Cardigan
3X-Large	45.5 cm (or 18 in)	60 cm (or 24 in)	158 cm (or 63 in)

Start with a Magic Circle or Ch 4 and sl st in 1st chain to form ring.

Round 1: If starting with a magic circle, ch 2. If starting with the ch ring, chain 3. In the center of your ring, work 11 dc. Sl st in the 1st of the row (*see above in the “important tips” section how to work your sl st*). (12)

Round 2: Ch 2, turn work and work one more dc in the same st. [Work 2 dc in every stitch all around] x 11. Sl st in the 1st st of the row. (24)

Round 3: Ch 2, turn work and work one more dc in the same st. [Work 1 dc in next st, 2dc in the next one] x 11. Finish row by working 1 dc in the last st. Sl st in the 1st st of the row. (36)

Round 4: Ch 2, turn work and work one more dc in the same st. [Work 1 dc in the next 2 st, 2dc in the 3rd one] x 11. Finish row by working 1 dc in the last 2 st. Sl st in the 1st st of the row. (48)

Round 5: Ch 2, turn work and work one more dc in the same st. [Work 1 dc in the next 3 st, 2dc in the 4th one] x 11. Finish row by working 1 dc in the last 3 st. Sl st in the 1st st of the row. (60)

Round 6: Ch 2, turn work and work one more dc in the same st. [Work 1 dc in the next 4 st, 2dc in the 5th one] x 11. Finish row by working 1 dc in the last 4 st. Sl st in the 1st st of the row. (72)

Round 7: Ch 2, turn work and work one more dc in the same st. [Work 1 dc in the next 5 st, 2dc in the 6th one] x 11. Finish row by working 1 dc in the last 5 st. Sl st in the 1st st of the row. (84)

Round 8: Ch 2, turn work. Starting from the next st, work 1 dc all around. Sl st in the 1st st of the row. (*in this row, we don't work any increases because the project has started to get a little wavy*). (84)

Round 9: Ch 2, turn work and work one more dc in the same st. [Work 1 dc in the next 6 st, 2dc in the 7th one] x 11. Finish row by working 1 dc in the last 6 st. Sl st in the 1st st of the row. (96)

Round 10: Ch 2, turn work and work one more dc in the same st. [Work 1 dc in the next 7 st, 2dc in the 8th one] x 11. Finish row by working 1 dc in the last 7 st. Sl st in the 1st st of the row. (108)

Round 11: Ch 2, turn work and work one more dc in the same st. [Work 1 dc in the next 8 st, 2dc in the 9th one] x 11. Finish row by working 1 dc in the last 8 st. Sl st in the 1st st of the row. (120)

Round 12: Ch 2, turn work and work one more dc in the same st. [Work 1 dc in the next 9 st, 2dc in the 10th one] x 11. Finish row by working 1 dc in the last 9 st. Sl st in the 1st st of the row. (132)

Round 13: Ch 2, turn work and work one more dc in the same st. [Work 1 dc in the next 10 st, 2dc in the 11th one] x 11. Finish row by working 1 dc in the last 10 st. Sl st in the 1st st of the row. (144)

Round 14: Ch 2, turn work and work one more dc in the same st. [Work 1 dc in the next 11 st, 2dc in the 12th one] x 11. Finish row by working 1 dc in the last 11 st. Sl st in the 1st st of the row. (156)

Round 15: Ch 2, turn work and work one more dc in the same st. [Work 1 dc in the next 12 st, 2dc in the 13th one] x 11. Finish row by working 1 dc in the last 12 st. Sl st in the 1st st of the row. (168)

Round 16: Ch 2, turn work and work one more dc in the same st. [Work 1 dc in the next 13 st, 2dc in the 14th one] x 11. Finish row by working 1 dc in the last 13 st. Sl st in the 1st st of the row. (180)

Round 17: Ch 2, turn work and work one more dc in the same st. [Work 1 dc in the next 14 st, 2dc in the 15th one] x 11. Finish row by working 1 dc in the last 14 st. Sl st in the 1st st of the row. (192)

Round 18: Ch 2, turn work and work one more dc in the same st. [Work 1 dc in the next 15 st, 2dc in the 16th one] x 11. Finish row by working 1 dc in the last 15 st. Sl st in the 1st st of the row. (204)

Round 19: Ch 2, turn work and work one more dc in the same st. [Work 1 dc in the next 16 st, 2dc in the 17th one] x 11. Finish row by working 1 dc in the last 16 st. Sl st in the 1st st of the row. (216)

Round 20: In this row we're going to create the sleeve openings, so we aren't going to work any increases. The end st count, along with the ch will be 216 again.

Ch 2 and turn work. Starting from the next st, work 35 dc. (this is the top of your vest)

Ch 29, sk 29 st and work 1 dc in the 30th st (1st sleeve opening).

Work 1 dc in the next 85 st (this is the bottom of your vest).

Ch 29, sk 29 st and work 1 dc in the 30th (2nd sleeve opening).

Finish by working 1 dc in the last 35 st. (this is the top of your vest).



Round 21: Note - *From this row on, we're going to work increases again. In the st count of this row, the ch that we have worked for the sleeve openings count as st as well, so we work in the ch and not under them.*

Ch 2, turn work and work one more dc in the same st. [Work 1 dc in the next 17 st, 2dc in the 18th one] x 11. Finish row by working 1 dc in the last 18 st. Sl st in the 1st st of the row. Sl st in the 1st st of the row. (228)

Round 22: Ch 2, turn work and work one more dc in the same st. [Work 1 dc in the next 18 st, 2dc in the 19th one] x 11. Finish row by working 1 dc in the last 18 st. Sl st in the 1st st of the row. (240)

Round 23: Ch 2, turn work and work one more dc in the same st. [Work 1 dc in the next 19 st, 2dc in the 20th one] x 11. Finish row by working 1 dc in the last 19 st. Sl st in the 1st st of the row. (252)

Round 24: Ch 2, turn work and work one more dc in the same st. [Work 1 dc in the next 20 st, 2dc in the 21st one] x 11. Finish row by working 1 dc in the last 20 st. Sl st in the 1st st of the row. (264)

Round 25: Ch 2, turn work and work one more dc in the same st. [Work 1 dc in the next 21 st, 2dc in the 22nd one] x 11. Finish row by working 1 dc in the last 21 st. Sl st in the 1st st of the row. (276)

Round 26: Ch 2, turn work and work one more dc in the same st. [Work 1 dc in the next 22 st, 2dc in the 23rd one] x 11. Finish row by working 1 dc in the last 22 st. Sl st in the 1st st of the row. (288)

Round 27: Ch 2, turn work and work one more dc in the same st. [Work 1 dc in the next 23 st, 2dc in the 24th one] x 11. Finish row by working 1 dc in the last 23 st. Sl st in the 1st st of the row. (300)

Round 28: Ch 2, turn work and work one more dc in the same st. [Work 1 dc in the next 24 st, 2dc in the 25th one] x 11. Finish row by working 1 dc in the last 24 st. Sl st in the 1st st of the row. (312)

Round 29: Ch 2, turn work and work one more dc in the same st. [Work 1 dc in the next 25 st, 2dc in the 26th one] x 11. Finish row by working 1 dc in the last 25 st. Sl st in the 1st st of the row. (324)

Round 30: Ch 2, turn work and work one more dc in the same st. [Work 1 dc in the next 26 st, 2dc in the 27th one] x 11. Finish row by working 1 dc in the last 26 st. Sl st in the 1st st of the row. (336)

Round 31: Ch 2, turn work and work one more dc in the same st. [Work 1 dc in the next 27 st, 2dc in the 28th one] x 11. Finish row by working 1 dc in the last 27 st. Sl st in the 1st st of the row. (348)

Round 32: Ch 2, turn work and work one more dc in the same st. [Work 1 dc in the next 28 st, 2dc in the 29th one] x 11. Finish row by working 1 dc in the last 28 st. Sl st in the 1st st of the row. (360)

Round 33: Ch 2, turn work and work one more dc in the same st. [Work 1 dc in the next 29 st, 2dc in the 30th one] x 11. Finish row by working 1 dc in the last 29 st. Sl st in the 1st st of the row. (372)

Round 34: Ch 2, turn work and work one more dc in the same st. [Work 1 dc in the next 30 st, 2dc in the 31st one] x 11. Finish row by working 1 dc in the last 30 st. Sl st in the 1st st of the row. (384)

Round 35: Ch 2, turn work and work one more dc in the same st. [Work 1 dc in the next 31 st, 2dc in the 32nd one] x 11. Finish row by working 1 dc in the last 31 st. Sl st in the 1st st of the row. (396)

Round 36: Ch 2, turn work and work one more dc in the same st. [Work 1 dc in the next 32 st, 2dc in the 33rd one] x 11. Finish row by working 1 dc in the last 32 st. Sl st in the 1st st of the row. (408)

Round 37: Ch 2, turn work and work one more dc in the same st. [Work 1 dc in the next 33 st, 2dc in the 34th one] x 11. Finish row by working 1 dc in the last 33 st. Sl st in the 1st st of the row. (420)

Round 38: Ch 2, turn work and work one more dc in the same st. [Work 1 dc in the next 34 st, 2dc in the 35th one] x 11. Finish row by working 1 dc in the last 34 st. Sl st in the 1st st of the row. (432)

Round 39: Ch 2, turn work and work one more dc in the same st. [Work 1 dc in the next 35 st, 2dc in the 36th one] x 11. Finish row by working 1 dc in the last 35 st. Sl st in the 1st st of the row. (444)

Round 40: Ch 2, turn work and work one more dc in the same st. [Work 1 dc in the next 36 st, 2dc in the 37th one] x 11. Finish row by working 1 dc in the last 36 st. Sl st in the 1st st of the row. (456)

Round 41: Ch 2, turn work and work one more dc in the same st. [Work 1 dc in the next 37 st, 2dc in the 38th one] x 11. Finish row by working 1 dc in the last 37 st. Sl st in the 1st st of the row. (468)

Round 42: Ch 2, turn work and work one more dc in the same st. [Work 1 dc in the next 38 st, 2dc in the 39th one] x 11. Finish row by working 1 dc in the last 38 st. Sl st in the 1st st of the row. (480)

Round 43: Ch 2, turn work and work one more dc in the same st. [Work 1 dc in the next 39 st, 2dc in the 40th one] x 11. Finish row by working 1 dc in the last 39 st. Sl st in the 1st st of the row. (492)

Round 44: Ch 2, turn work and work one more dc in the same st. [Work 1 dc in the next 40 st, 2dc in the 41st one] x 11. Finish row by working 1 dc in the last 40 st. Sl st in the 1st st of the row. (504)

Round 45: Ch 2, turn work and work one more dc in the same st. [Work 1 dc in the next 41 st, 2dc in the 42nd one] x 11. Finish row by working 1 dc in the last 41 st. Sl st in the 1st st of the row. (516)

Round 46: Ch 2, turn work and work one more dc in the same st. [Work 1 dc in the next 42 st, 2dc in the 43rd one] x 11. Finish row by working 1 dc in the last 42 st. Sl st in the 1st st of the row. (528)

Round 47: Ch 2, turn work and work one more dc in the same st. [Work 1 dc in the next 43 st, 2dc in the 44th one] x 11. Finish row by working 1 dc in the last 43 st. Sl st in the 1st st of the row. (540)

Round 48: Ch 2, turn work and work one more dc in the same st. [Work 1 dc in the next 44 st, 2dc in the 45th one] x 11. Finish row by working 1 dc in the last 44 st. Sl st in the 1st st of the row. (552)

Round 49: Ch 2, turn work and work one more dc in the same st. [Work 1 dc in the next 45 st, 2dc in the 46th one] x 11. Finish row by working 1 dc in the last 45 st. Sl st in the 1st st of the row. (564)

Round 50: Ch 2, turn work and work one more dc in the same st. [Work 1 dc in the next 46 st, 2dc in the 47th one] x 11. Finish row by working 1 dc in the last 46 st. Sl st in the 1st st of the row. (576)

Round 51: Ch 2, turn work and work one more dc in the same st. [Work 1 dc in the next 47 st, 2dc in the 48th one] x 11. Finish row by working 1 dc in the last 47 st. Sl st in the 1st st of the row. (588)

Round 52: Ch 2, turn work and work one more dc in the same st. [Work 1 dc in the next 48 st, 2dc in the 49th one] x 11. Finish row by working 1 dc in the last 48 st. Sl st in the 1st st of the row. (600)

The Ribbing:

Round 53: *(Trust me, it's easier to crochet than what it looks when written out)* Ch 3 and turn work. Work [1 fptr in the next st, 1 bptr in the next one] x 24. For the increase, which will be worked in the next st, the 50th one, work 1 fptr and 1 dc in the same st (see photo below how to work the increase correctly).



* Continue by working [1 fptr in the next st, then 1 bptr in the next one] x 24, then 1 fptr in the next st. For the increase, which will be worked in the next st, the 50th one, work 1 bptr and 1 dc in the same st. Continue by working [1 bptr in the next st, then 1 fptr in the next one] x 24, then 1 bptr in the next st. For the increase, which will be worked in the next st, the 50th one, work 1 fptr and 1 dc in the same st **.

Work from * to ** 4 more times.

Finish the row by working [1 fptr in the next st, then 1 bptr in the next one] x 24, then 1 fptr in the next st. For the increase, which will be worked in the next st, the 50th one, work 1 bptr and 1 dc in the same st. Sl st in the 1st st of the row. (612)

Round 54: Ch 2 and turn work. [work 1 fpdc in the next st and then 1 bpdc in the next one] x 306. Sl st in the 1st st of the row. (612)

And your cardigan is complete!! Ch 1, cut the yarn and fasten off. Weave in all of your ends.

Size	Shoulder to Shoulder	Diameter of Circle in Row 20	Diameter of Cardigan
4X-Large	47 cm (or 18.5 in)	64 cm (or 25.6 in)	166 cm (or 66.4 in)

Start with a Magic Circle or Ch 4 and sl st in 1st chain to form ring.

Round 1: If starting with a magic circle, ch 2. If starting with the ch ring, chain 3. In the center of your ring, work 11 dc. Sl st in the 1st of the row (*see above in the “important tips” section how to work your sl st*). (12)

Round 2: Ch 2, turn work and work one more dc in the same st. [Work 2 dc in every stitch all around] x 11. Sl st in the 1st st of the row. (24)

Round 3: Ch 2, turn work and work one more dc in the same st. [Work 1 dc in next st, 2dc in the next one] x 11. Finish row by working 1 dc in the last st. Sl st in the 1st st of the row. (36)

Round 4: Ch 2, turn work and work one more dc in the same st. [Work 1 dc in the next 2 st, 2dc in the 3rd one] x 11. Finish row by working 1 dc in the last 2 st. Sl st in the 1st st of the row. (48)

Round 5: Ch 2, turn work and work one more dc in the same st. [Work 1 dc in the next 3 st, 2dc in the 4th one] x 11. Finish row by working 1 dc in the last 3 st. Sl st in the 1st st of the row. (60)

Round 6: Ch 2, turn work and work one more dc in the same st. [Work 1 dc in the next 4 st, 2dc in the 5th one] x 11. Finish row by working 1 dc in the last 4 st. Sl st in the 1st st of the row. (72)

Round 7: Ch 2, turn work and work one more dc in the same st. [Work 1 dc in the next 5 st, 2dc in the 6th one] x 11. Finish row by working 1 dc in the last 5 st. Sl st in the 1st st of the row. (84)

Round 8: Ch 2, turn work. Starting from the next st, work 1 dc all around. Sl st in the 1st st of the row. (*in this row, we don't work any increases because the project has started to get a little wavy*). (84)

Round 9: Ch 2, turn work and work one more dc in the same st. [Work 1 dc in the next 6 st, 2dc in the 7th one] x 11. Finish row by working 1 dc in the last 6 st. Sl st in the 1st st of the row. (96)

Round 10: Ch 2, turn work and work one more dc in the same st. [Work 1 dc in the next 7 st, 2dc in the 8th one] x 11. Finish row by working 1 dc in the last 7 st. Sl st in the 1st st of the row. (108)

Round 11: Ch 2, turn work and work one more dc in the same st. [Work 1 dc in the next 8 st, 2dc in the 9th one] x 11. Finish row by working 1 dc in the last 8 st. Sl st in the 1st st of the row. (120)

Round 12: Ch 2, turn work and work one more dc in the same st. [Work 1 dc in the next 9 st, 2dc in the 10th one] x 11. Finish row by working 1 dc in the last 9 st. Sl st in the 1st st of the row. (132)

Round 13: Ch 2, turn work and work one more dc in the same st. [Work 1 dc in the next 10 st, 2dc in the 11th one] x 11. Finish row by working 1 dc in the last 10 st. Sl st in the 1st st of the row. (144)

Round 14: Ch 2, turn work and work one more dc in the same st. [Work 1 dc in the next 11 st, 2dc in the 12th one] x 11. Finish row by working 1 dc in the last 11 st. Sl st in the 1st st of the row. (156)

Round 15: Ch 2, turn work and work one more dc in the same st. [Work 1 dc in the next 12 st, 2dc in the 13th one] x 11. Finish row by working 1 dc in the last 12 st. Sl st in the 1st st of the row. (168)

Round 16: Ch 2, turn work and work one more dc in the same st. [Work 1 dc in the next 13 st, 2dc in the 14th one] x 11. Finish row by working 1 dc in the last 13 st. Sl st in the 1st st of the row. (180)

Round 17: Ch 2, turn work and work one more dc in the same st. [Work 1 dc in the next 14 st, 2dc in the 15th one] x 11. Finish row by working 1 dc in the last 14 st. Sl st in the 1st st of the row. (192)

Round 18: Ch 2, turn work and work one more dc in the same st. [Work 1 dc in the next 15 st, 2dc in the 16th one] x 11. Finish row by working 1 dc in the last 15 st. Sl st in the 1st st of the row. (204)

Round 19: Ch 2, turn work and work one more dc in the same st. [Work 1 dc in the next 16 st, 2dc in the 17th one] x 11. Finish row by working 1 dc in the last 16 st. Sl st in the 1st st of the row. (216)

Round 20: Ch 2, turn work and work one more dc in the same st. [Work 1 dc in the next 17 st, 2dc in the 18th one] x 11. Finish row by working 1 dc in the last 16 st. Sl st in the 1st st of the row. (228)

Round 21: In this row we're going to create the sleeve openings, so we aren't going to work any increases. The end st count, along with the ch will be 228 again.

Ch 2 and turn work. Starting from the next st, work 37 dc. (this is the top of your vest)

Ch 31, sk 31 st and work 1 dc in the 32nd st (1st sleeve opening).

Work 1 dc in the next 89 st (this is the bottom of your vest).

Ch 31, sk 31 st and work 1 dc in the 32nd (2nd sleeve opening).

Finish by working 1 dc in the last 37 st. (this is the top of your vest).



Round 22: Note - From this row on, we're going to work increases again. In the st count of this row, the ch that we have worked for the sleeve openings count as st as well, so we work in the ch and not under them.

Ch 2, turn work and work one more dc in the same st. [Work 1 dc in the next 18 st, 2dc in the 19th one] x 11. Finish row by working 1 dc in the last 18 st. Sl st in the 1st st of the row. (240)

Round 23: Ch 2, turn work and work one more dc in the same st. [Work 1 dc in the next 19 st, 2dc in the 20th one] x 11. Finish row by working 1 dc in the last 19 st. Sl st in the 1st st of the row. (252)

Round 24: Ch 2, turn work and work one more dc in the same st. [Work 1 dc in the next 20 st, 2dc in the 21st one] x 11. Finish row by working 1 dc in the last 20 st. Sl st in the 1st st of the row. (264)

Round 25: Ch 2, turn work and work one more dc in the same st. [Work 1 dc in the next 21 st, 2dc in the 22nd one] x 11. Finish row by working 1 dc in the last 21 st. Sl st in the 1st st of the row. (276)

Round 26: Ch 2, turn work and work one more dc in the same st. [Work 1 dc in the next 22 st, 2dc in the 23rd one] x 11. Finish row by working 1 dc in the last 22 st. Sl st in the 1st st of the row. (288)

Round 27: Ch 2, turn work and work one more dc in the same st. [Work 1 dc in the next 23 st, 2dc in the 24th one] x 11. Finish row by working 1 dc in the last 23 st. Sl st in the 1st st of the row. (300)

Round 28: Ch 2, turn work and work one more dc in the same st. [Work 1 dc in the next 24 st, 2dc in the 25th one] x 11. Finish row by working 1 dc in the last 24 st. Sl st in the 1st st of the row. (312)

Round 29: Ch 2, turn work and work one more dc in the same st. [Work 1 dc in the next 25 st, 2dc in the 26th one] x 11. Finish row by working 1 dc in the last 25 st. Sl st in the 1st st of the row. (324)

Round 30: Ch 2, turn work and work one more dc in the same st. [Work 1 dc in the next 26 st, 2dc in the 27th one] x 11. Finish row by working 1 dc in the last 26 st. Sl st in the 1st st of the row. (336)

Round 31: Ch 2, turn work and work one more dc in the same st. [Work 1 dc in the next 27 st, 2dc in the 28th one] x 11. Finish row by working 1 dc in the last 27 st. Sl st in the 1st st of the row. (348)

Round 32: Ch 2, turn work and work one more dc in the same st. [Work 1 dc in the next 28 st, 2dc in the 29th one] x 11. Finish row by working 1 dc in the last 28 st. Sl st in the 1st st of the row. (360)

Round 33: Ch 2, turn work and work one more dc in the same st. [Work 1 dc in the next 29 st, 2dc in the 30th one] x 11. Finish row by working 1 dc in the last 29 st. Sl st in the 1st st of the row. (372)

Round 34: Ch 2, turn work and work one more dc in the same st. [Work 1 dc in the next 30 st, 2dc in the 31st one] x 11. Finish row by working 1 dc in the last 30 st. Sl st in the 1st st of the row. (384)

Round 35: Ch 2, turn work and work one more dc in the same st. [Work 1 dc in the next 31 st, 2dc in the 32nd one] x 11. Finish row by working 1 dc in the last 31 st. Sl st in the 1st st of the row. (396)

Round 36: Ch 2, turn work and work one more dc in the same st. [Work 1 dc in the next 32 st, 2dc in the 33rd one] x 11. Finish row by working 1 dc in the last 32 st. Sl st in the 1st st of the row. (408)

Round 37: Ch 2, turn work and work one more dc in the same st. [Work 1 dc in the next 33 st, 2dc in the 34th one] x 11. Finish row by working 1 dc in the last 33 st. Sl st in the 1st st of the row. (420)

Round 38: Ch 2, turn work and work one more dc in the same st. [Work 1 dc in the next 34 st, 2dc in the 35th one] x 11. Finish row by working 1 dc in the last 34 st. Sl st in the 1st st of the row. (432)

Round 39: Ch 2, turn work and work one more dc in the same st. [Work 1 dc in the next 35 st, 2dc in the 36th one] x 11. Finish row by working 1 dc in the last 35 st. Sl st in the 1st st of the row. (444)

Round 40: Ch 2, turn work and work one more dc in the same st. [Work 1 dc in the next 36 st, 2dc in the 37th one] x 11. Finish row by working 1 dc in the last 36 st. Sl st in the 1st st of the row. (456)

Round 41: Ch 2, turn work and work one more dc in the same st. [Work 1 dc in the next 37 st, 2dc in the 38th one] x 11. Finish row by working 1 dc in the last 37 st. Sl st in the 1st st of the row. (468)

Round 42: Ch 2, turn work and work one more dc in the same st. [Work 1 dc in the next 38 st, 2dc in the 39th one] x 11. Finish row by working 1 dc in the last 38 st. Sl st in the 1st st of the row. (480)

Round 43: Ch 2, turn work and work one more dc in the same st. [Work 1 dc in the next 39 st, 2dc in the 40th one] x 11. Finish row by working 1 dc in the last 39 st. Sl st in the 1st st of the row. (492)

Round 44: Ch 2, turn work and work one more dc in the same st. [Work 1 dc in the next 40 st, 2dc in the 41st one] x 11. Finish row by working 1 dc in the last 40 st. Sl st in the 1st st of the row. (504)

Round 45: Ch 2, turn work and work one more dc in the same st. [Work 1 dc in the next 41 st, 2dc in the 42nd one] x 11. Finish row by working 1 dc in the last 41 st. Sl st in the 1st st of the row. (516)

Round 46: Ch 2, turn work and work one more dc in the same st. [Work 1 dc in the next 42 st, 2dc in the 43rd one] x 11. Finish row by working 1 dc in the last 42 st. Sl st in the 1st st of the row. (528)

Round 47: Ch 2, turn work and work one more dc in the same st. [Work 1 dc in the next 43 st, 2dc in the 44th one] x 11. Finish row by working 1 dc in the last 43 st. Sl st in the 1st st of the row. (540)

Round 48: Ch 2, turn work and work one more dc in the same st. [Work 1 dc in the next 44 st, 2dc in the 45th one] x 11. Finish row by working 1 dc in the last 44 st. Sl st in the 1st st of the row. (552)

Round 49: Ch 2, turn work and work one more dc in the same st. [Work 1 dc in the next 45 st, 2dc in the 46th one] x 11. Finish row by working 1 dc in the last 45 st. Sl st in the 1st st of the row. (564)

Round 50: Ch 2, turn work and work one more dc in the same st. [Work 1 dc in the next 46 st, 2dc in the 47th one] x 11. Finish row by working 1 dc in the last 46 st. Sl st in the 1st st of the row. (576)

Round 51: Ch 2, turn work and work one more dc in the same st. [Work 1 dc in the next 47 st, 2dc in the 48th one] x 11. Finish row by working 1 dc in the last 47 st. Sl st in the 1st st of the row. (588)

Round 52: Ch 2, turn work and work one more dc in the same st. [Work 1 dc in the next 48 st, 2dc in the 49th one] x 11. Finish row by working 1 dc in the last 48 st. Sl st in the 1st st of the row. (600)

Round 53: Ch 2, turn work and work one more dc in the same st. [Work 1 dc in the next 49 st, 2dc in the 50th one] x 11. Finish row by working 1 dc in the last 49 st. Sl st in the 1st st of the row. (612)

Round 54: Ch 2, turn work and work one more dc in the same st. [Work 1 dc in the next 50 st, 2dc in the 51st one] x 11. Finish row by working 1 dc in the last 50 st. Sl st in the 1st st of the row. (624)

The Ribbing:

Round 55: *(Trust me, it's easier to crochet than what it looks when written out)* Ch 3 and turn work. Work [1 fptr in the next st, 1 bptr in the next one] x 25. For the increase, which will be worked in the next st, the 52nd one, work 1 fptr and 1 dc in the same st (see photo below how to work the increase correctly).

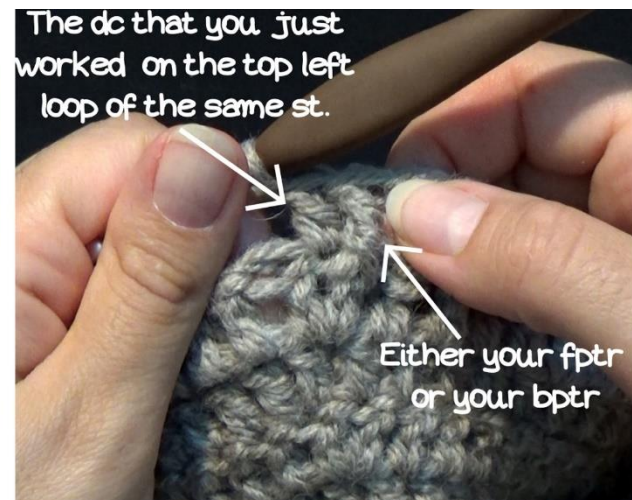

* Continue by working [1 fptr in the next st, then 1 bptr in the next one] x 25, then 1 fptr in the next st. For the increase, which will be worked in the next st, the 52nd one, work 1 bptr and 1 dc in the same st. Continue by working [1 bptr in the next st, then 1 fptr in the next one] x 25, then 1 bptr in the next st. For the increase, which will be worked in the next st, the 52nd one, work 1 fptr and 1 dc in the same st **.

Work from * to ** 4 more times.

Finish the row by working [1 fptr in the next st, then 1 bptr in the next one] x 25, then 1 fptr in the next st. For the increase, which will be worked in the next st, the 52nd one, work 1 bptr and 1 dc in the same st. Sl st in the 1st st of the row. (636)

Round 56: Ch 2 and turn work. [work 1 fpdc in the next st and then 1 bpdc in the next one] x 318. Sl st in the 1st st of the row. (636)

And your cardigan is complete!! Ch 1, cut the yarn and fasten off. Weave in all of your ends.

Size	Shoulder to Shoulder	Diameter of Circle in Row 21	Diameter of Cardigan
5X-Large	47 cm (or 18.5 in)	68 cm (or 27 in)	174 cm (or 69.5 in)

Start with a Magic Circle or Ch 4 and sl st in 1st chain to form ring.

Round 1: If starting with a magic circle, ch 2. If starting with the ch ring, chain 3. In the center of your ring, work 11 dc. Sl st in the 1st of the row (*see above in the “important tips” section how to work your sl st*). (12)

Round 2: Ch 2, turn work and work one more dc in the same st. [Work 2 dc in every stitch all around] x 11. Sl st in the 1st st of the row. (24)

Round 3: Ch 2, turn work and work one more dc in the same st. [Work 1 dc in next st, 2dc in the next one] x 11. Finish row by working 1 dc in the last st. Sl st in the 1st st of the row. (36)

Round 4: Ch 2, turn work and work one more dc in the same st. [Work 1 dc in the next 2 st, 2dc in the 3rd one] x 11. Finish row by working 1 dc in the last 2 st. Sl st in the 1st st of the row. (48)

Round 5: Ch 2, turn work and work one more dc in the same st. [Work 1 dc in the next 3 st, 2dc in the 4th one] x 11. Finish row by working 1 dc in the last 3 st. Sl st in the 1st st of the row. (60)

Round 6: Ch 2, turn work and work one more dc in the same st. [Work 1 dc in the next 4 st, 2dc in the 5th one] x 11. Finish row by working 1 dc in the last 4 st. Sl st in the 1st st of the row. (72)

Round 7: Ch 2, turn work and work one more dc in the same st. [Work 1 dc in the next 5 st, 2dc in the 6th one] x 11. Finish row by working 1 dc in the last 5 st. Sl st in the 1st st of the row. (84)

Round 8: Ch 2, turn work. Starting from the next st, work 1 dc all around. Sl st in the 1st st of the row. (*in this row, we don't work any increases because the project has started to get a little wavy*). (84)

Round 9: Ch 2, turn work and work one more dc in the same st. [Work 1 dc in the next 6 st, 2dc in the 7th one] x 11. Finish row by working 1 dc in the last 6 st. Sl st in the 1st st of the row. (96)

Round 10: Ch 2, turn work and work one more dc in the same st. [Work 1 dc in the next 7 st, 2dc in the 8th one] x 11. Finish row by working 1 dc in the last 7 st. Sl st in the 1st st of the row. (108)

Round 11: Ch 2, turn work and work one more dc in the same st. [Work 1 dc in the next 8 st, 2dc in the 9th one] x 11. Finish row by working 1 dc in the last 8 st. Sl st in the 1st st of the row. (120)

Round 12: Ch 2, turn work and work one more dc in the same st. [Work 1 dc in the next 9 st, 2dc in the 10th one] x 11. Finish row by working 1 dc in the last 9 st. Sl st in the 1st st of the row. (132)

Round 13: Ch 2, turn work and work one more dc in the same st. [Work 1 dc in the next 10 st, 2dc in the 11th one] x 11. Finish row by working 1 dc in the last 10 st. Sl st in the 1st st of the row. (144)

Round 14: Ch 2, turn work and work one more dc in the same st. [Work 1 dc in the next 11 st, 2dc in the 12th one] x 11. Finish row by working 1 dc in the last 11 st. Sl st in the 1st st of the row. (156)

Round 15: Ch 2, turn work and work one more dc in the same st. [Work 1 dc in the next 12 st, 2dc in the 13th one] x 11. Finish row by working 1 dc in the last 12 st. Sl st in the 1st st of the row. (168)

Round 16: Ch 2, turn work and work one more dc in the same st. [Work 1 dc in the next 13 st, 2dc in the 14th one] x 11. Finish row by working 1 dc in the last 13 st. Sl st in the 1st st of the row. (180)

Round 17: Ch 2, turn work and work one more dc in the same st. [Work 1 dc in the next 14 st, 2dc in the 15th one] x 11. Finish row by working 1 dc in the last 14 st. Sl st in the 1st st of the row. (192)

Round 18: Ch 2, turn work and work one more dc in the same st. [Work 1 dc in the next 15 st, 2dc in the 16th one] x 11. Finish row by working 1 dc in the last 15 st. Sl st in the 1st st of the row. (204)

Round 19: Ch 2, turn work and work one more dc in the same st. [Work 1 dc in the next 16 st, 2dc in the 17th one] x 11. Finish row by working 1 dc in the last 16 st. Sl st in the 1st st of the row. (216)

Round 20: Ch 2, turn work and work one more dc in the same st. [Work 1 dc in the next 17 st, 2dc in the 18th one] x 11. Finish row by working 1 dc in the last 17 st. Sl st in the 1st st of the row. (228)

Round 21: Ch 2, turn work and work one more dc in the same st. [Work 1 dc in the next 18 st, 2dc in the 19th one] x 11. Finish row by working 1 dc in the last 18 st. Sl st in the 1st st of the row. (240)

Round 22: In this row we're going to create the sleeve openings, so we aren't going to work any increases. The end st count, along with the ch will be 240 again.

Ch 2 and turn work. Starting from the next st, work 39 dc. (this is the top of your vest)

Ch 33, sk 33 st and work 1 dc in the 34th st (1st sleeve opening).

Work 1 dc in the next 93 st (this is the bottom of your vest).

Ch 33, sk 33 st and work 1 dc in the 34th (2nd sleeve opening).

Finish by working 1 dc in the last 39 st. (this is the top of your vest).



Round 23: Note - From this row on, we're going to work increases again. In the st count of this row, the ch that we have worked for the sleeve openings count as st as well, so we work in the ch and not under them.

Ch 2, turn work and work one more dc in the same st. [Work 1 dc in the next 19 st, 2dc in the 20th one] x 11. Finish row by working 1 dc in the last 19 st. Sl st in the 1st st of the row. (252)

Round 24: Ch 2, turn work and work one more dc in the same st. [Work 1 dc in the next 20 st, 2dc in the 21st one] x 11. Finish row by working 1 dc in the last 20 st. Sl st in the 1st st of the row. (264)

Round 25: Ch 2, turn work and work one more dc in the same st. [Work 1 dc in the next 21 st, 2dc in the 22nd one] x 11. Finish row by working 1 dc in the last 21 st. Sl st in the 1st st of the row. (276)

Round 26: Ch 2, turn work and work one more dc in the same st. [Work 1 dc in the next 22 st, 2dc in the 23rd one] x 11. Finish row by working 1 dc in the last 22 st. Sl st in the 1st st of the row. (288)

Round 27: Ch 2, turn work and work one more dc in the same st. [Work 1 dc in the next 23 st, 2dc in the 24th one] x 11. Finish row by working 1 dc in the last 23 st. Sl st in the 1st st of the row. (300)

Round 28: Ch 2, turn work and work one more dc in the same st. [Work 1 dc in the next 24 st, 2dc in the 25th one] x 11. Finish row by working 1 dc in the last 24 st. Sl st in the 1st st of the row. (312)

Round 29: Ch 2, turn work and work one more dc in the same st. [Work 1 dc in the next 25 st, 2dc in the 26th one] x 11. Finish row by working 1 dc in the last 25 st. Sl st in the 1st st of the row. (324)

Round 30: Ch 2, turn work and work one more dc in the same st. [Work 1 dc in the next 26 st, 2dc in the 27th one] x 11. Finish row by working 1 dc in the last 26 st. Sl st in the 1st st of the row. (336)

Round 31: Ch 2, turn work and work one more dc in the same st. [Work 1 dc in the next 27 st, 2dc in the 28th one] x 11. Finish row by working 1 dc in the last 27 st. Sl st in the 1st st of the row. (348)

Round 32: Ch 2, turn work and work one more dc in the same st. [Work 1 dc in the next 28 st, 2dc in the 29th one] x 11. Finish row by working 1 dc in the last 28 st. Sl st in the 1st st of the row. (360)

Round 33: Ch 2, turn work and work one more dc in the same st. [Work 1 dc in the next 29 st, 2dc in the 30th one] x 11. Finish row by working 1 dc in the last 29 st. Sl st in the 1st st of the row. (372)

Round 34: Ch 2, turn work and work one more dc in the same st. [Work 1 dc in the next 30 st, 2dc in the 31st one] x 11. Finish row by working 1 dc in the last 30 st. Sl st in the 1st st of the row. (384)

Round 35: Ch 2, turn work and work one more dc in the same st. [Work 1 dc in the next 31 st, 2dc in the 32nd one] x 11. Finish row by working 1 dc in the last 31 st. Sl st in the 1st st of the row. (396)

Round 36: Ch 2, turn work and work one more dc in the same st. [Work 1 dc in the next 32 st, 2dc in the 33rd one] x 11. Finish row by working 1 dc in the last 32 st. Sl st in the 1st st of the row. (408)

Round 37: Ch 2, turn work and work one more dc in the same st. [Work 1 dc in the next 33 st, 2dc in the 34th one] x 11. Finish row by working 1 dc in the last 33 st. Sl st in the 1st st of the row. (420)

Round 38: Ch 2, turn work and work one more dc in the same st. [Work 1 dc in the next 34 st, 2dc in the 35th one] x 11. Finish row by working 1 dc in the last 34 st. Sl st in the 1st st of the row. (432)

Round 39: Ch 2, turn work and work one more dc in the same st. [Work 1 dc in the next 35 st, 2dc in the 36th one] x 11. Finish row by working 1 dc in the last 35 st. Sl st in the 1st st of the row. (444)

Round 40: Ch 2, turn work and work one more dc in the same st. [Work 1 dc in the next 36 st, 2dc in the 37th one] x 11. Finish row by working 1 dc in the last 36 st. Sl st in the 1st st of the row. (456)

Round 41: Ch 2, turn work and work one more dc in the same st. [Work 1 dc in the next 37 st, 2dc in the 38th one] x 11. Finish row by working 1 dc in the last 37 st. Sl st in the 1st st of the row. (468)

Round 42: Ch 2, turn work and work one more dc in the same st. [Work 1 dc in the next 38 st, 2dc in the 39th one] x 11. Finish row by working 1 dc in the last 38 st. Sl st in the 1st st of the row. (480)

Round 43: Ch 2, turn work and work one more dc in the same st. [Work 1 dc in the next 39 st, 2dc in the 40th one] x 11. Finish row by working 1 dc in the last 39 st. Sl st in the 1st st of the row. (492)

Round 44: Ch 2, turn work and work one more dc in the same st. [Work 1 dc in the next 40 st, 2dc in the 41st one] x 11. Finish row by working 1 dc in the last 40 st. Sl st in the 1st st of the row. (504)

Round 45: Ch 2, turn work and work one more dc in the same st. [Work 1 dc in the next 41 st, 2dc in the 42nd one] x 11. Finish row by working 1 dc in the last 41 st. Sl st in the 1st st of the row. (516)

Round 46: Ch 2, turn work and work one more dc in the same st. [Work 1 dc in the next 42 st, 2dc in the 43rd one] x 11. Finish row by working 1 dc in the last 42 st. Sl st in the 1st st of the row. (528)

Round 47: Ch 2, turn work and work one more dc in the same st. [Work 1 dc in the next 43 st, 2dc in the 44th one] x 11. Finish row by working 1 dc in the last 43 st. Sl st in the 1st st of the row. (540)

Round 48: Ch 2, turn work and work one more dc in the same st. [Work 1 dc in the next 44 st, 2dc in the 45th one] x 11. Finish row by working 1 dc in the last 44 st. Sl st in the 1st st of the row. (552)

Round 49: Ch 2, turn work and work one more dc in the same st. [Work 1 dc in the next 45 st, 2dc in the 46th one] x 11. Finish row by working 1 dc in the last 45 st. Sl st in the 1st st of the row. (564)

Round 50: Ch 2, turn work and work one more dc in the same st. [Work 1 dc in the next 46 st, 2dc in the 47th one] x 11. Finish row by working 1 dc in the last 46 st. Sl st in the 1st st of the row. (576)

Round 51: Ch 2, turn work and work one more dc in the same st. [Work 1 dc in the next 47 st, 2dc in the 48th one] x 11. Finish row by working 1 dc in the last 47 st. Sl st in the 1st st of the row. (588)

Round 52: Ch 2, turn work and work one more dc in the same st. [Work 1 dc in the next 48 st, 2dc in the 49th one] x 11. Finish row by working 1 dc in the last 48 st. Sl st in the 1st st of the row. (600)

Round 53: Ch 2, turn work and work one more dc in the same st. [Work 1 dc in the next 49 st, 2dc in the 50th one] x 11. Finish row by working 1 dc in the last 49 st. Sl st in the 1st st of the row. (612)

Round 54: Ch 2, turn work and work one more dc in the same st. [Work 1 dc in the next 50 st, 2dc in the 51st one] x 11. Finish row by working 1 dc in the last 50 st. Sl st in the 1st st of the row. (624)

Round 55: Ch 2, turn work and work one more dc in the same st. [Work 1 dc in the next 51 st, 2dc in the 52nd one] x 11. Finish row by working 1 dc in the last 51 st. Sl st in the 1st st of the row. (636)

Round 56: Ch 2, turn work and work one more dc in the same st. [Work 1 dc in the next 52 st, 2dc in the 53rd one] x 11. Finish row by working 1 dc in the last 52 st. Sl st in the 1st st of the row. (648)

The Ribbing:

Round 57: *(Trust me, it's easier to crochet than what it looks when written out)* Ch 3 and turn work. Work [1 fptr in the next st, 1 bptr in the next one] x 26. For the increase, which will be worked in the next st, the 54th one, work 1 fptr and 1 dc in the same st (see photo below how to work the increase correctly).

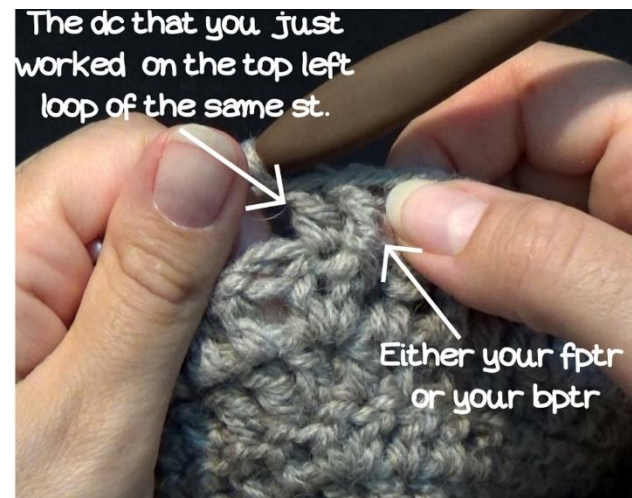
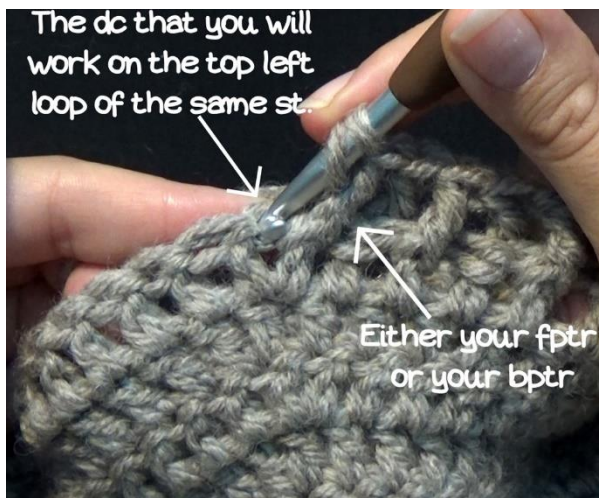

* Continue by working [1 fptr in the next st, then 1 bptr in the next one] x 26, then 1 fptr in the next st. For the increase, which will be worked in the next st, the 54th one, work 1 bptr and 1 dc in the same st. Continue by working [1 bptr in the next st, then 1 fptr in the next one] x 26, then 1 bptr in the next st. For the increase, which will be worked in the next st, the 54th one, work 1 fptr and 1 dc in the same st **.

Work from * to ** 4 more times.

Finish the row by working [1 fptr in the next st, then 1 bptr in the next one] x 26, then 1 fptr in the next st. For the increase, which will be worked in the next st, the 54th one, work 1 bptr and 1 dc in the same st. Sl st in the 1st st of the row. (660)

Round 58: Ch 2 and turn work. [work 1 fpdc in the next st and then 1 bpdc in the next one] x 330. Sl st in the 1st st of the row. (660)

And your cardigan is complete!! Ch 1, cut the yarn and fasten off. Weave in all of your ends.



Thank you for purchasing my pattern!

Please, if you have any questions concerning the pattern, don't hesitate to send me a message.

Please, don't forget to review the product once you have completed it. Your opinion is much appreciated!

✓ You may sell any finished products made with this pattern, as long as you give credit back to me and my shop (KikiCrochetPatterns) as the designer of the pattern. I would also be happy if you would provide a link back to my:



Website: <https://kikicrochetpatterns.com/>



Etsy Shop: <https://www.etsy.com/shop/KikiCrochetPatterns>



Ravelry Shop: <https://www.ravelry.com/designers/kiki-crochet-patterns>

Follow me on Social Media:



<https://www.facebook.com/KikiCrochetPatterns>



<https://www.instagram.com/kikicrochetpatterns/>



<https://gr.pinterest.com/KikiCrochetPatterns/>

